

MEETING NOTICE

A meeting of the
Bayside Traffic Committee
will be held in the Rockdale Town Hall - Pindari Room
Level 1, 448 Princes Highway, Rockdale
on **Wednesday 7 February 2018 at 9.15am**

AGENDA

1 ATTENDANCE AND APOLOGIES

2 DISCLOSURES OF INTEREST

3 MINUTES OF PREVIOUS MEETINGS

BTC18.001	Minutes of the Bayside Traffic Committee Meeting - 6 December 2017	3
-----------	--	---

4 REPORTS

BTC18.002	Argyle Street, west of Princes Highway, Arncliffe, rear of 12 Arncliffe Street - proposed 'No Parking' restriction	10
BTC18.003	Banks Street, between Cecil Street and O'Connell Street, Monterey - proposed 90 degree angle parking	14
BTC18.004	Chamberlain Road, Bexley - Proposed 'No Stopping' sign near Eddystone Road	17
BTC18.005	2a Eddystone Road, Bexley, north of Stoney Creek Road - proposed 'Motorbikes Parking Only between Driveways'	20
BTC18.006	Gear Up Girl Challenge 2018 - Bicycle Ride - Sunday 11 March 2018 - proposed road closure in Innesdale Road and Levey Street west of Marsh Street, Wolli Creek, between 7 am and 10.45 am	24
BTC18.007	Geeves Avenue west of Princes Highway, Rockdale - proposed convert P5 minute parking to P15 Minute	45
BTC18.008	Haran Street at the side of 133 O'Riordon Street, Mascot - Proposed Works Zone.....	49
BTC18.009	Julian Close, new road, south of Corish Circle, Hillsdale - Proposed 'No Stopping' restriction	52
BTC18.010	King Street, Mascot - Proposed Works Zone for property at 904 Botany Road.....	56
BTC18.011	King Street eastern approach to George Street, Rockdale - proposed change GIVE WAY to STOP	59
BTC18.012	Laycock Street, and Donnan Street near Stoney Creek Road, Bexley- proposed removal of two bus zones and installation of a bus zone respectively	63

BTC18.013	Moate Avenue, Brighton Le Sands - Detailed Design Drawings for proposed roundabouts at the intersections with Henson Street and Sellwood Street	67
BTC18.014	O'Neill Street and Wycombe Avenue, Brighton Le Sands - Proposed double barrier centre lines and supplementary 'Give Way' signs	71
BTC18.015	Shaw Street, Bexley North - Proposed signposting of 'NST' and 'Bus Zone' restrictions	74
BTC18.016	14 Trevelyan Street, Botany - Proposed 1P Parking.....	77
BTC18.017	Waines Crescent southern leg, northern kerb line, west of Princes Highway, Rockdale - Proposed conversion of 'Loading Zone, 24/7' to a combined 'Loading Zone, 11am - 4pm, Mon - Fri' and 'No Stopping, at other times'	80
BTC18.018	General Business Session - Additional Items	84

5 GENERAL BUSINESS

Bayside Traffic Committee

7/02/2018

Item No	BTC18.001
Subject	Minutes of the Bayside Traffic Committee Meeting - 6 December 2017
Report by	Jeremy Morgan, Manager City Infrastructure
File	SC18/2

Officer Recommendation

That the Minutes of the Bayside Traffic Committee meeting held on 6 December 2017 be confirmed as a true record of proceedings.

Present

Councillor Ed McDougall – Convenor
Senior Constable Alexander Weissel, Botany Bay Police,
Mark Carruthers, representing Roads and Maritime Services,
George Perivolarellis, representing State Members for Rockdale and Heffron,
Les Crompton, representing State Member for Kogarah.

Also present

Jeremy Morgan, Manager City Infrastructure, Bayside Council,
Pintara Lay, Coordinator Traffic and Road Safety, Bayside Council,
Lyn Moore, NSW Pedestrian Council,
Peter Whitney, State Transit Authority - west
Joe Scarpignato, St George Cabs,
Peter Hannett, St George Bicycle User Group,
Glen McKeachie, Coordinator Regulations, Bayside Council,
David Carroll, Senior Parking Patrol Officer, Bayside Council,
Michael Lee, Traffic Engineer, Bayside Council,
Hamoon Bahari, Student Engineer, Bayside Council,
Pat Hill, Traffic Committee Administration Officer, Bayside Council,
Greg Hastie, Impact Group (Item BTC17.182),
Steve Wellmen, Parking & Traffic Consultants (Item BTC17.182).

The Convenor opened the meeting in the Rockdale Library - 2nd Floor Meeting Room 3.2, 444-446 Princes Highway, Rockdale at 10.00 am.

1 Apologies

The following apologies were received:

Traffic Sergeant Frank Gaal, St George Local Area Command,

2 Disclosures of Interest

There were no disclosures of interest.

3 Minutes of Previous Meetings

BTC17.173 Minutes of the Bayside Traffic Committee Meeting - 1 November 2017

Committee Recommendation

- 1 That the Minutes of the Bayside Traffic Committee meeting held on 1 November 2017 be confirmed as a true record of proceedings.
- 2 That it be noted that the Committee recommendations included in the Minutes of the Bayside Traffic Committee meeting held on 01 November 2017 were adopted by the Council at its meeting held on 8 November, 2017 except for the following:

BTC17.153 Chamberlain Road west of Bexley Road, Bexley – proposed parking restriction.

That the report be deferred for further consultation and an on-site meeting be held with interested Councillors.

BTC17.165 Somerville Street, Arncliffe, south of Forest Road, detailed drawings for traffic calming scheme.

That the matter be deferred for further consultation and there be an on-site meeting for Councillors and interested parties.

BTC17.166 Waratah Road, Botany – Proposed Works Zone.

That this item be deferred to the next meeting of the Traffic Committee on 6 December 2017 for further investigation.

4 Reports

BTC17.174 Clarkes Road at Margate Street Intersection, Ramsgate Proposed 'Rumble bar filled island'

Committee Recommendation

That approval be given to the installation of a rumble bar filled island in Clarkes Road at Margate Street, Ramsgate.

BTC17.175 16 and 18 Linden Street, Mascot - proposed 'Motor Bikes Parking Only' restriction between driveways

Committee Recommendation

That approval be given to the installation of 'Motorbikes Parking Only' restriction between driveways of Nos. 16 and 18 Linden Street, Mascot.

BTC17.176 Walz Street east of Hesten Lane, Rockdale - Proposed Loading Zone

Committee Recommendation

That approval be given to install a Loading Zone with parking restrictions on the southern kerbline of Walz Street, east of Hesten Lane and to rearrange 1/4P parking restrictions as follows:

- 1 From 0m to 4.5m – retain existing ‘No Stopping’ restriction
- 2 From 4.5m to 16.5m – replace the existing 12m of ‘1/4P’ parking restriction with 12m ‘Loading Zone, 8 am – 6 pm’ restriction.
- 3 From 16.5m eastward, retain existing ‘1/4P, 8 am – 6.00 pm Mon – Fri and 8.30am- 12.30 pm Sat’ and ‘No Stopping’ restrictions.

BTC17.177 General Business Session - Additional Item

Committee Recommendation

That this report be received and noted.

BTC17.178 Waratah Road, Botany, at 1356 Botany Street - proposed Works zone

Committee Recommendation

- 1 That approval be given to the installation of 22m of ‘Works Zone, 7.00 am - 6.00 pm, Mon – Fri and 8.00 am – 4.00 pm, Sat’ restriction in Waratah Road for No.1356 Botany Road, Botany, for a duration of up to 30 weeks, as the Works Zone in Botany Road has been removed and the 1 hour parking restored.
- 2 That developers/builders be requested to comply with Council’s relevant conditions of Works Zone and to have a traffic control plan to manage the work site and surrounding areas including Waratah Road, Hanna Street, Fremlin Street and Botany Road.

BTC17.179 Wolli Creek Road - Detailed design drawings for proposed traffic calming scheme

Committee Recommendation

- 1 That 10m statutory ‘No Stopping’ restrictions be installed along Wolli Creek Road on either side of its intersection with Fairview Street.
- 2 That 10m statutory ‘No Stopping’ restrictions be installed along Wolli Creek Road on both sides south of its intersection with Lorraine Avenue.
- 3 That 10m statutory ‘No Stopping’ restrictions be installed along Wolli Creek Road on either side of its intersection with Oswald Street.

- 4 That 10m statutory 'No Stopping' restrictions be installed along Wolli Creek Road south of its intersection with Atkinson Street.
- 5 That approval be given to the installation of centre lanes lines and parking lane lines with RRPMS along the entire length of Wolli Creek Road and Kimpton Street.
- 6 That approval be given to the installation of TB lines between existing traffic islands in Wolli Creek Road at its intersection with Gardiner Avenue to improve safety for right turning traffic.
- 7 That approval be given to the installation of speed humps on approach to the pedestrian refuge on Wolli Creek Road north of Gardiner Avenue to improve traffic and pedestrian safety.
- 8 That approval be given to the installation of speed humps on approach to the pedestrian refuge in Gardiner Avenue east of Wolli Creek Road to improve traffic and pedestrian safety.
- 9 That approval be given to the installation of an upgraded pedestrian refuge in Wollongong Road east of Wolli Creek Road to improve pedestrian safety and provide effective traffic delineation.
- 10 That approval be given to the installation of additional street light on approach to the pedestrian refuge on Wolli Creek Road north of Gardiner Avenue.

**BTC17.180 Florence Street Car Park east of The Grand Parade,
Ramsgate - proposed modification to the car park**

Committee Recommendation

That approval be given to the installation of traffic regulation in 'Florence Street Car Park' east of The Grand Parade, Ramsgate, as follows:

- 1 the separation of a shared bicycle/pedestrian path from the vehicular traffic.
- 2 the introduction of the one way street, anti-clockwise direction, to manage the traffic flow in the car park.
- 3 The installation of associated regulatory traffic signs and road pavements in the car park to accommodate the separation of the shared bicycle/pedestrian path from the moving vehicular traffic, and the proposed one way street.

**BTC17.181 Scarborough Street Car Park east of The Grand Parade,
Monterey - proposed change to the one way street**

Committee Recommendation

- 1 That approval be given to the introduction of the one way street, anti-clockwise direction, to manage the traffic flow in the car park.
- 2 That the proposed arrangements affecting the Grand Parade, including closing the gap in the median island and modifications to the entry and exist points be

forwarded to Roads and Maritime Services for consideration as it involves work on a State Road.

BTC17.182 Malua Street, and Russell Avenue, Dolls Point - proposed children's crossing and 'No Parking' restriction

Committee Recommendation

- 1 That approval be given to the installation of a school children's crossing and associated regulatory traffic signs and road marking in Malua Street north of Russell Avenue.
- 2 That approval be given to the installation of 'No Parking, 8am-9:30am and 2:30pm-4pm, School Days' and 'Kiss and Ride Area' restriction along the northern kerb line of Russell Avenue east of Malua Street, Dolls Point for seven (7) cars.
- 3 That the school be requested to manage the display of school children's crossing flags during the periods of usage by school children at the Children's Crossing and removal of flags at conclusion of its usage.
- 4 That the Roads and Maritime Services, Speed Management Section, be requested to consider provision of a 40km/h school zones in Gannon Street, Malua Street and Russell Avenue.

BTC17.183 Benjamin Street rear of Bexley North Public School-north of Canonbury Grove - Proposed "No Stopping" yellow line marking

Committee Recommendation

That the proposed "No Stopping" yellow line marking be approved along the eastern kerb line of Benjamin Street north of Canonbury Grove, Bexley North.

BTC17.184 Edward Street, west of Caroline Street, Kingsgrove - proposed marked footcrossing

Committee Recommendation

- 1 That consultation be carried with affected residents in Edward Street and Caroline Street, including the 3 school managements and the P&C Associations, regarding a proposal to implement a marked footcrossing in Edward Street west of Caroline Street, Kingsgrove.
- 2 That results of consultation be presented to the Traffic Committee for further consideration.

BTC17.185 45 McBurney Road, Botany, south of Wentworth Avenue - Proposed Works Zone

Committee Recommendation

That approval be given to the installation of 6m of 'Works Zone, 7am- 3pm, Mon – Fri and 8am- 1pm, Sat' restriction in McBurney Avenue for Nos.45 McBurney Avenue, Botany, for a duration of 16 weeks, subject to relevant conditions.

BTC17.186 Keats Avenue at the rear of Nos. 533- 537 Princes Highway, Rockdale - Proposed 'Works Zone'

Committee Recommendation

That approval be given to the installation of 30m of 'Works Zone, 7am- 6:30pm, Mon – Fri and 8:30am- 3:30pm, Sat' restriction in Keats Avenue for Nos. 533- 537 Princes Highway, Rockdale, for a duration of 26 weeks, subject to relevant conditions.

BTC17.187 Cook Street, Turrella - Proposed signposting of 'No Stopping' restrictions along the retaining wall

Committee Recommendation

- 1 That approval be given for the signposting of 109m 'No Stopping' restrictions along southern side of Cook Street along the retaining wall, east of Victoria Street, Turrella.
- 2 That effected residents be notified of Council's decision prior to the installation of the 'No Stopping' restriction and the item be implemented subject to no objections being received from the residents.

BTC17.188 No. 9 Florence Avenue, Eastlakes, opposite Eastlakes Public School - proposed 'No Parking'

Committee Recommendation

- 1 That approval be given to the installation of 14m 'No Parking' across the driveway of No. 9 Florence Avenue, opposite Eastlakes Public School.
- 2 That the school Principal and Windgap Association be requested to advise the parents of the school children and visitors not to park across the driveway of 9 Florence Avenue Eastlakes.

BTC17.189 Swinbourne Street, Botany, east of Wilson Street - Proposed gap in the landscaped median island

Committee Recommendation

- 1 That this proposal not be supported by the Committee.
- 2 That further options be investigated to enhance pedestrian safety in the area.

BTC17.190 Dalley Avenue in front of Pagewood Senior Citizens Club - proposed 'No Stopping, 8:00am-9:30am and 2:30pm-3:30pm, School Days'

Committee Recommendation

That approval be given to the installation of 6m of 'No Stopping, 8am-9:30am, and 2:30pm-4pm, School Days, along the eastern kerb line of Dalley Avenue, in front of Pagewood Senior Citizens Club.

BTC17.191 Wollongong Road between Forest Road and Hamilton Street Arncliffe - proposed traffic calming scheme

Committee Recommendation

- 1 That endorsement in principle be given to the concept plan of a lateral deflection island in Wollongong Road at Hamilton Street to reduce the speed of traffic in Wollongong Road.
- 2 That detailed plan of the proposed island be presented to the Traffic Committee for further consideration.

BTC17.192 27 Church Avenue, and 22 John Street, Mascot Proposed Works Zones

Committee Recommendation

- 1 That approval be given to the installation of 20 m of 'Works Zone, 7am- 3pm, Mon – Fri and 8am- 1pm, Sat' restriction in Church Avenue for 27 Church Avenue, Mascot, for a duration of 52 weeks, subject to relevant conditions.
- 2 That the application for the works zone in John Street, Mascot, not be supported as it will affect current kerb side parking on the opposite site of the construction site due to road narrowness.

5 General Business

There were no additional items raised.

The Convenor closed the meeting at 11.30 am.

Bayside Traffic Committee

7/02/2018

Item No	BTC18.002
Subject	Argyle Street, west of Princes Highway, Arncliffe, rear of 12 Arncliffe Street - proposed 'No Parking' restriction
Report by	Pintara Lay, Coordinator Traffic and Road Safety
File	SC18/2
Electorate	Rockdale Electorate, Rockdale Ward, TRIM

Summary

Council has received a request to install 'No Parking' restriction in Argyle Street at the rear of No. 12 Arncliffe Street, Arncliffe, to provide vehicular access to and from the Princes Highway.

Officer Recommendation

That approval be given to the installation of 'No Parking' restriction along the northern kerb line of Argyle Street, between the Princes Highway and the rear of No. 12 Arncliffe Street, Arncliffe.

- 1 From 0m to a point 10m – Retain existing 'No Stopping' restriction.
 - 2 From 10m to 84m - Proposed 'No Parking' restriction.
-

Background

Currently, Argyle Street at the rear of No. 12 Arncliffe Street, near to South Western Sydney Ocean Outfall Structure (SWSOOS) is 7.8m wide. Parking is allowed on both sides of the street while the road is a two way street.

The commercial premises at No. 12 Arncliffe Street, Arncliffe, is an automotive group which that received deliveries via long vehicles through Argyle Street. Interstate deliveries arrive via train and the freight is then transported via semi-trailer to these premises via Argyle Street entrance. This area is primarily industrial in nature and it is the only viable access point for deliveries.

Vehicles parked next to the site entrance in Argyle Street, make it difficult for trucks to safely manouvere into the driveway.

It is recommended to install 'No Parking' restrictions in Argyle Street west of Princes Highway as shown in the attached drawing TC1421.

Financial Implications

Not applicable



Included in existing approved budget	<input checked="" type="checkbox"/>	Block grant for traffic facilities on local streets
Additional funds required	<input type="checkbox"/>	<<Enter comment if required or delete>>

Community Engagement

Affected business people to be advised of Council's decision.

Attachments

- 1 Argyle Street proposed No Parking drawing TC1421
- 2 Argyle Street aerial map

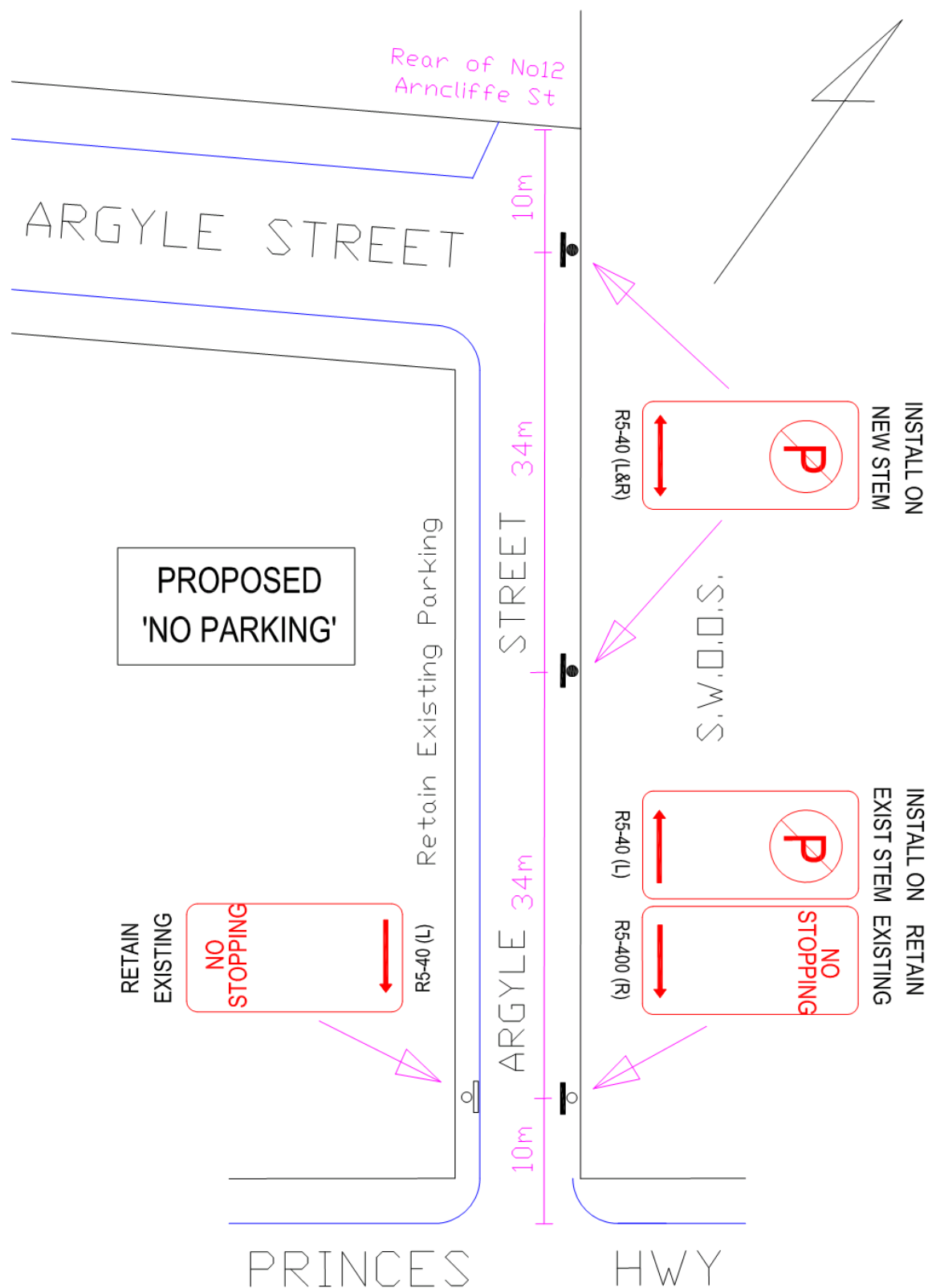

G/TS/T&RS/JM/Argyle St NP TC1421



ARGYLE STREET,
BETWEEN REAR OF 12 ARNCLIFFE STREET AND PRINCES HIGHWAY
PROPOSED 'NO PARKING' RESTRICTION ON THE NORTHERN KERB LINE

Bayside Traffic Committee

7/02/2018

Item No	BTC18.003
Subject	Banks Street, between Cecil Street and O'Connell Street, Monterey - proposed 90 degree angle parking
Report by	Pintara Lay, Coordinator Traffic and Road Safety
File	SC18/2
Electorate	Rockdale Electorate, Botany Bay Ward, TRIM18/10514, CRM194311

Summary

Council has received a request for the provision of more parking in Banks Street between Cecil Street and O'Connell Street,

Officer Recommendation

- 1 That community engagement be undertake with affected residents in Banks Street, Cecil Street, and Wycombe Avenue and O'Connell Street to determine the level of support for additional on-street parking in Banks Street.
 - 2 That results of public consultation be submitted to the Traffic Committee for further consideration.
-

Background

The on-street parking in Banks Street is divided into two arrangements:

- 1 90 degree angle parking between The Grand Parade and Wycombe Avenue/Cecil Street. Most of the properties are residential flat buildings.
- 2 Parallel parking between Wycombe Avenue/Cecil Street and O'Connell Street – parallel parking on both sides. Most of the properties are residential houses.

There is photographic evidence to suggest that people have been parking at 90degrees at the eastern end of Banks Street since the 1960's.

The road carriageway width is 18.4m wide between Cecil Street and O'Connell Street, Monterey. In accordance with Australian Standard AS 2890.5 – Parking Facilities – Part 5: On-street Parking, the minimim overall width required from kerb line to separation line for the volume less than 800 vehicles per hour, is 12.6m, as shown in the attached drawing.

The current width of Banks Street which is 18.4m, is considered sufficient for 90 degree angle parking on both sides of the street.

An alternative maybe to provide a centre of road parking area. This will reduce the direct impact to adjoining properties by moving the cars further away from the dwelling frontage, however this type of arrangement generates additional pedestrian movements across the road.

Two parking surveys were conducted in 2011 and 2014 to determine the level of support for the proposed 90 degree angle parking in Banks Street between Wycombe Avenue/Cecil Street and O'Connell Street with affected residents of Banks Street between O'Connell Street and Wycombe Street. The survey did not extend to surrounding areas. The survey targeted those who would be most affected by the proposal to their properties and frontage in Banks Street between Wycombe Avenue/Cecil Street and O'Connell Street. On both occasions, there were insufficient support for the proposed parking change.

The latest survey which was carried out in February 2014 with affected households showed that, out of 30 responses;

- 1 - was in support;
- 28 – were against; and,
- 1 – other.

The majority of objectors live in residential houses, not residential flat buildings.

Financial Implications

- | | | |
|--------------------------------------|-------------------------------------|---|
| Not applicable | <input type="checkbox"/> | |
| Included in existing approved budget | <input checked="" type="checkbox"/> | The installation of 90 degree angle parking in Banks Street will be funded through the block grant for traffic facilities |
| Additional funds required | <input type="checkbox"/> | <<Enter comment if required or delete>> |

Community Engagement

Affected residents to be advised of Council's decision.

Attachments

AS 2890.1 page NO. 15 90 degree angle drawing

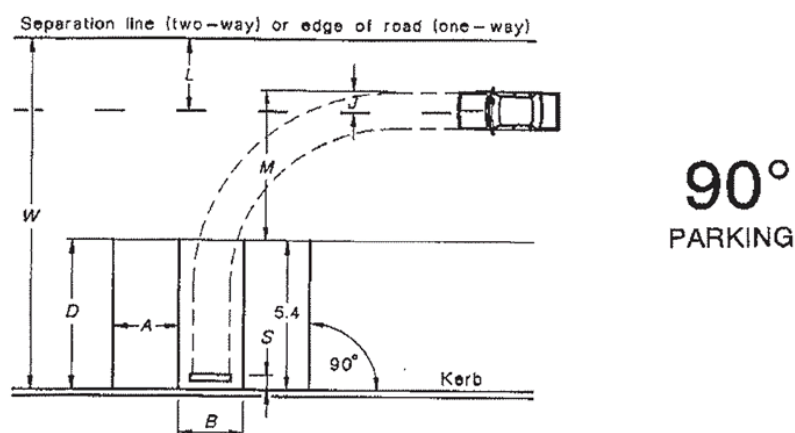

Dimensions		Use category (see Table 2.2)			
		Low	Medium	High	Disabled
A—space width		2.4	2.5	2.6	3.2
B—space width parallel to kerb		Same as Dimension A			
D—lateral depth of spaces (Note 1)	D_1	5.4	5.4	5.4	5.4
	D_2	4.8	4.8	4.8	4.8
	D_3	5.4	5.4	5.4	5.4
M—manoeuvre space (Note 2)		6.2	5.8	5.4	5.4
J—allowable encroachment into adjacent traffic lanes (Note 3)		2.5	2.5	2.5	2.5
Minimum width required, kerb line to outer edge of a moving traffic lane = $D + M - J$		9.1	8.7	8.3	8.3
L—width of lane(s) for moving traffic:					
0-800 vehicles/hour (Note 4)		3.5	3.5	3.5	3.5
800-1600 vehicles/hour (Note 4)		6.5	6.5	6.5	6.5
W—minimum overall width required, kerb line to separation line = $D + M - J + L$:					
0-800 vehicles/hour (Note 4)		12.6	12.2	11.8	11.8
800-1600 vehicles/hour (Note 4)		16.1	15.7	15.3	15.3
S—wheelstop distance:					
Nose-in parking		0.6	0.6	0.6	0.6
Rear-in parking		0.9	0.9	0.9	0.9

DIMENSIONS IN METRES

NOTES:

- Dimension D is selected as follows (see Note 2):
 - where parking is to a wall or high kerb not allowing any overhang.
 - where parking is to a low kerb which allows 600 mm overhang.
 - where parking is controlled by wheelstops installed at right angles to the direction of parking.
- Formulae from which values of D_1 , D_2 and D_3 have been calculated are given in AS 2890.1.
- Dimension M gives the lateral space required when manoeuvring into or out of a parking space. Roadway width limitations are dealt with further in Clause 2.4.
- Dimension J is the extent to which a vehicle can be allowed to obstruct the adjacent moving traffic lane while manoeuvring into or out of a parking space. The value $J = 2.5$ m is appropriate to traffic speeds of 60 km/h or less past the site. At higher speeds it is recommended that J be reduced by 1.0 m for each 10 km/h by which the speed exceeds 60 km/h, with a minimum value of $J = 0$.
- The quoted traffic volumes are one-way maximum hourly volumes, total of all lanes, during the times parking is permitted.

FIGURE 2.5 LAYOUT AND MINIMUM ROADWAY WIDTH FOR 90 DEGREE ANGLE PARKING SPACES

COPYRIGHT

Bayside Traffic Committee

7/02/2018

Item No	BTC18.004
Subject	Chamberlain Road, Bexley - Proposed 'No Stopping' sign near Eddystone Road
Report by	Agasteena Patel, Traffic Engineer
File	SC18/2
Electorate	Rockdale Electorate and Bexley Ward

Summary

Council has received a request from residents for the installation of parking restrictions in the northern part of Chamberlain Road south of Eddystone Road, Bexley.

This matter was previously dealt with by Bayside Traffic Committee at its meeting on 1 November 2017, item BTC153. The Committee recommendation was presented to Council for consideration on 8 November 2017.

Council resolved that the report be deferred for further consultation and an on-site meeting be held with interested Councillors.

Officer Recommendation

That approval be given for the installation of 10m 'No Stopping' restrictions on the western kerbline of Chamberlain Road, Bexley, south of Eddystone Road.

Background

Council received a request to review the parking and access arrangements for the upper end of Chamberlain Road near Eddystone Road, with concerns that the road is too narrow for the two-way street with parking allowed on both sides of the road.

Chamberlain Road is a residential street which is split into two levels. Each level of Chamberlain Road provides service for two-way traffic flow.

The top end of Chamberlain Road forms an intersection with Eddystone Road and currently does not have signposted 'No Stopping' restrictions. It has a steep slope toward Bexley Road.

The top level has a cul de sac end on the eastern side. It has a paved footpath and a stairway on one side.

The road carriageway width of this section of Chamberlain Road is approximately 5.1m wide.

No accidents have been reported in Chamberlain Road for the period of five years between 2012 and 2016.

This matter was previously considered by the Bayside Traffic Committee at its meeting on 1 November 2017, item BTC153. The Committee recommendation was presented to Council for consideration on 8 November 2017.

Council resolved that the report be deferred for further consultation and an on-site meeting be held with interested Councillors.

Subsequently, a meeting was organised on 27 November 2017 at 4:30pm. Present at the meeting were Councillor Ed McDougall, Council's Manager of City Infrastructure and Traffic and Road Safety Coordinator. Some residents of Chamberlain Road spoke with Council representatives on site.

The attendees of the meeting recommended to maintain existing parking on both sides of Chamberlain Road immediately north west of Bexley Road. It was also viewed that a part of Chamberlain Road near Eddystone Road should be signposted with 'No Stopping' restriction as this area is restricted by parked vehicles.

It is recommended to signpost the statutory 10m 'No Stopping' restrictions in Chamberlain Road near Eddystone as shown in the attached drawing TC1416.

Financial Implications

Not applicable	<input type="checkbox"/>	
Included in existing approved budget	<input checked="" type="checkbox"/>	Block grant for traffic facilities in local streets
Additional funds required	<input type="checkbox"/>	

Community Engagement

Affected residents be advised of Council's decision.

Attachments

Chamberlain Road near Eddystone Road - proposed No Stopping drawing TC1416

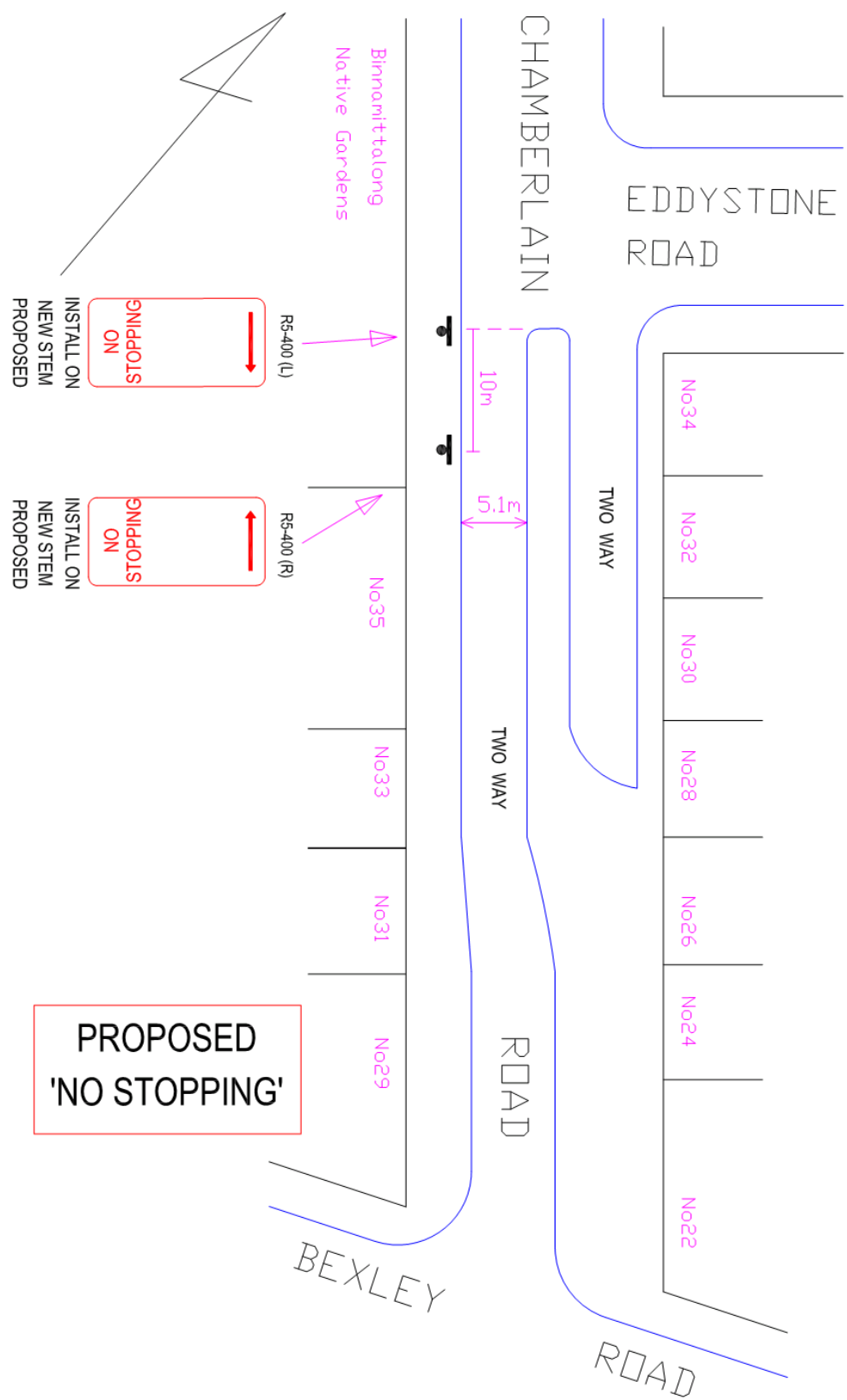

G/TS/T&RS/JM/Chamberlain Rd NS TC1416

Bayside Traffic Committee

7/02/2018

Item No	BTC18.005
Subject	2a Eddystone Road, Bexley, north of Stoney Creek Road - proposed 'Motorbikes Parking Only between Driveways'
Report by	Pintara Lay, Coordinator Traffic and Road Safety
File	SC18/2
Electorate	Kogarah Electorate, Bexley Ward, TRIM17/119568

Summary

Council has received a request for the provision of 'No Parking' restriction in Eddystone Road, across three driveways at Nos. 2 A Eddystone Road, 94 and 100 Stoney Creek Road, Bexley, due to parked vehicles blocking their vehicular access.

Officer Recommendation

That approval be given to the installation of 'Motorbikes Parking Only between Driveways' in Eddystone Road north of Stoney Creek Road in front of three driveways at Nos. 2a Eddystone Road, 94 and 100 Stoney Creek Road, Bexley.

Background

Currently, Eddystone Road is a residential street, north of Stoney Creek Road and Bexley Oval. The 2A property is situated around the bend and opposite an Aged Care Facility Centre. The gap between three driveways of Nos. 2A Eddystone Road, 94 and 100 Stoney Creek Road, in Eddystone Road is approximately 4m. This distance is too small to accommodate a standard car length. The properties at Nos. 94 and 100 Stoney Creek Road have their vehicular access via Eddystone Road, with No. 94 Stoney Creek Road being a commercial premise.

It is reported that cars are restricting access to the driveway in front of No. 2a Eddystone Road, Bexley daily as shown in the attached pictures. It makes access impossible for trucks and vehicles towing trailers of the commercial business generated from this site at No. 94 Stoney Creek Road. It is also dangerous when any vehicle is leaving the property, particularly when reversing, as vision is blocked or made difficult on the bend.

Council's Regulations Inspectors have been called upon on a few occasions to respond to issues. Two parking infringement notices had been issued to offending drivers who had committed a traffic offence by parking and blocking access to a driveway.

As this becomes an ongoing parking compliance concern, it is recommended to implement parking restriction signs to reinforce NSW Road Rules. It is recommended to install 'Motorbikes Parking Only between Driveways' restriction which will keep cars and trucks away from parking but it can be used for motorbikes parking. It will not affect the sight distance or access to 2A Eddystone Road, 94 and 100 Stoney Creek Road as shown in the attached drawing TC1427.

Financial Implications

Not applicable	<input type="checkbox"/>	
Included in existing approved budget	<input checked="" type="checkbox"/>	Block grant for traffic facilities on local streets
Additional funds required	<input type="checkbox"/>	<<Enter comment if required or delete>>

Community Engagement

Affected residents and business people in the area be advised of Council's decision.

Attachments

- 1 2a Eddystone Road driveway aerial map and pictures of blocking cars
- 2 Eddystone Road driveway Motorbikes Parking only between Driveways , TC1427 drawing



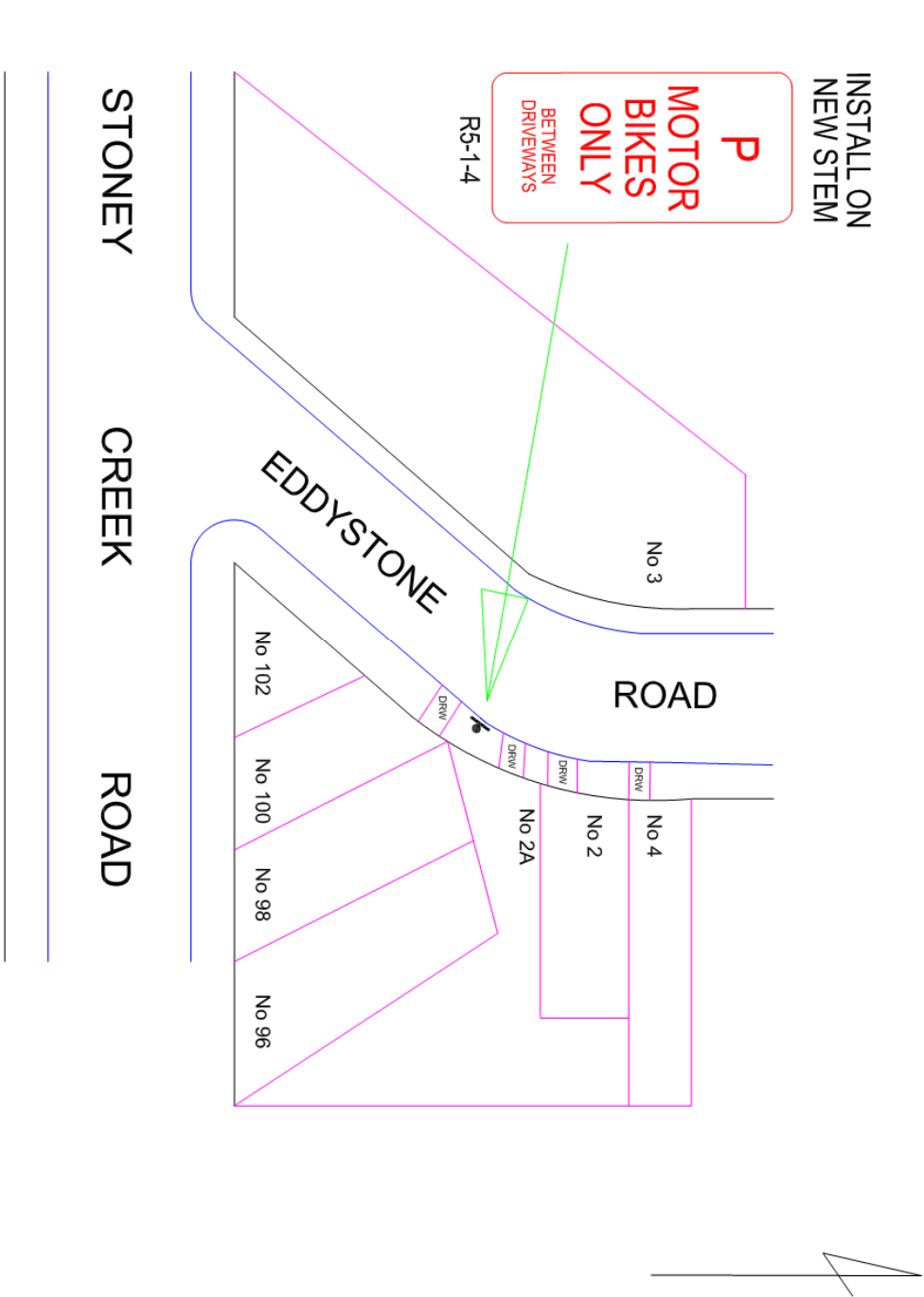

G/T/S/ED/T&RS/HAMMOON/EDDYSTONE ROAD - MOTORBIKE PARKING ONLY TC1427

Bayside Traffic Committee

7/02/2018

Item No	BTC18.006
Subject	Gear Up Girl Challenge 2018 - Bicycle Ride - Sunday 11 March 2018 - proposed road closure in Innesdale Road and Levey Street west of Marsh Street, Wolli Creek, between 7 am and 10.45 am
Report by	Pintara Lay, Coordinator Traffic and Road Safety
File	SC18/2
Electorate	Rockdale Electorate, Mascot Ward

Summary

Council has received a request to close some parts of Innesdale Road and Levey Street on Sunday 11 March 2018, between 7 am and 10.45 am for Gear Up Girl Challenge 2018 Bike Ride.

This is an annual event, but this year, the organisers wanted to close off Innesdale Road between Levey Street and Marsh Street and in Levey Street between Gertrude Street and Innesdale Road to vehicular traffic completely.

Officer Recommendation

- 1 That approval be given to the organisers of Gear Up Girl Challenge 2018, to temporarily close off Levey Street and Innesdale Road to vehicular traffic, with RMS qualified traffic controllers with STOP and SLOW signs and a traffic control plan, on Sunday 11 March 2018 between 7 am and 10.45 am.
 - 2 That Council be indemnified by the event organisers, against any claims directly or indirectly, arisen from the event.
-

Background

Innesdale Road is the only vital link to Marsh Street for Mercure Hotel, Sailing Club and Kogarah Golf Club, Tennis Court, Soccer Club, Airport shuttle businesses and businesses and local residents in that block of Wolli Creek as shown in the aerial map.

The event proposal has not included an alternative route for motorists if the proposed road closures of Innesdale Road and Levey Street west of Marsh Street are implemented. The alternate access for motorists seeking to enter the precinct from Marsh Street would require an approximate 1.6km diversion.

The proposed temporary closure to vehicular traffic completely in Innesdale Road and Levey Street as requested by the organisers, is not recommended for support. However, the organisers can operate the intersection under qualified traffic controllers with STOP and SLOW signs.

Attached are the traffic management plan of the event, combined map and the Police letter.

Financial Implications

Not applicable	<input type="checkbox"/>	
Included in existing approved budget	<input type="checkbox"/>	<<Enter comment if required or delete>>
Additional funds required	<input type="checkbox"/>	<<Enter comment if required or delete>>

Community Engagement

Affected residents and businesses in the area to be advised by the event organisers.

Attachments

- 1 Innesdale Road and Marsh Street Google Map
- 2 Gear Up Girl Challenge 2018 - Notification
- 3 Gear Up Girl Combined Map
- 4 Gear Up Girl Police Letter

01/02/2018

Innesdale Rd & Marsh St - Google Maps

Google Maps Innesdale Rd & Marsh St

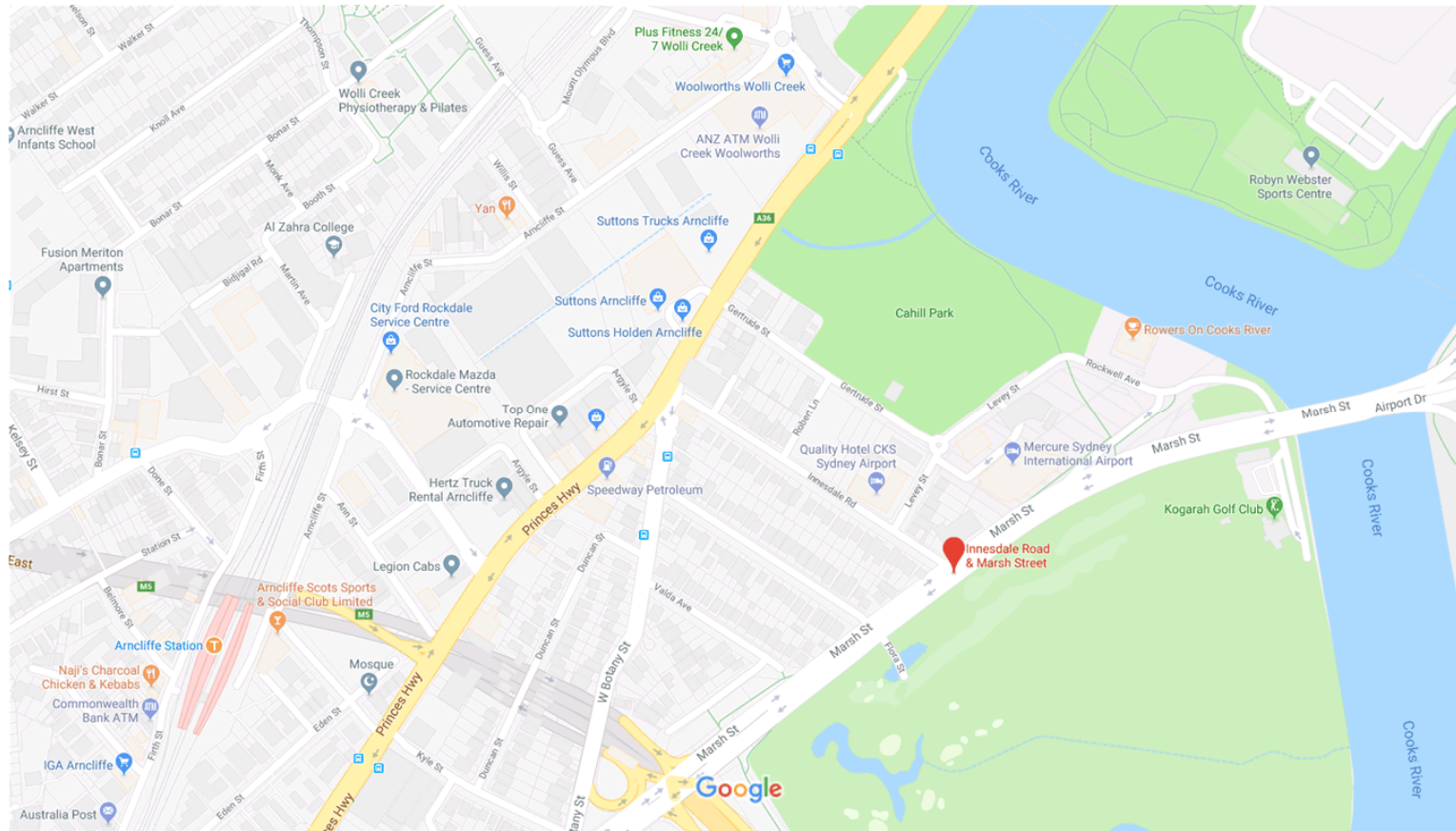

<https://www.google.com.au/maps/place/Innesdale+Rd+%26+Marsh+St,+Woll+Creek+NSW+2205/@-33.9339466,151.1536994,17z/data=!4m5!3m4!1s0x6b12b0966a0107b3:0xe8656a9adb7b69f3!8m2!3d-33.935535...> 1/3

01/02/2018

Innesdale Rd & Marsh St - Google Maps



Innesdale Rd & Marsh St
Wolli Creek NSW 2205



<https://www.google.com.au/maps/place/Innesdale+Rd+%26+Marsh+St,+Wolli+Creek+NSW+2205/@-33.9339466,151.1536994,17z/data=!4m5!3m4!1s0x6b12b0966a0107b3:0xe8656a9adb7b69f3!8m2!3d-33.935535...> 2/3

SPECIAL EVENT TRAFFIC AND TRANSPORT INFORMATION



GEAR UP GIRL CHALLENGE 2018

Date: Sunday 11 March 2018

Location: Bicentennial Park, Sydney Olympic Park; Cahill Park,
Wolli Creek; Bonna Point Reserve, Kurnell; and Don
Lucas Reserve, Cronulla

Road and Lane Closures will be in place in the Arncliffe/Wolli Creek areas on Sunday 11 March 2018 for Gear Up Girl Challenge 2018.

Roads and a Lane in the vicinity of Arncliffe/Wolli Creek will begin closing at 7:00am and will remain closed till 10:45am. Police and Traffic Controller may restrict vehicle access along closed roads, including recreational users, residents and businesses.

Special event clearways will not be in place for this event.

A reduced speed limit of 60km/hr will be in place along Captain Cook Drive between Gannon Road to Sir Joseph Banks Drive in eastbound direction and between Sir Joseph Banks Drive to Trinity Street in westbound direction between 6:00am and 1:30pm.

Gear Up Girl Challenge 2018 is an annual recreational, untimed (i.e. not a bicycle race) cycling event owned by Bicycle NSW. It consists of four different rides, as follows:

Ride	Route	Start & Finish Times	Maximum Patronage
80km Challenge Ride	Sydney Olympic Park to Cronulla via Kurnell	06:50am – 12:35pm	150
60km Coast Ride	Sydney Olympic Park to Cronulla via Kurnell	07:00am – 01:00pm	400
40km Classic Ride	Sydney Olympic Park to Cronulla	07:30am – 12:50pm	400
20km Beach Ride	Wolli Creek to Cronulla	08:00am – 11:50pm	350
Total:			1,300

The overall event will start at 6:50am at Bicentennial Park, Sydney Olympic Park and will be finished at 1:00pm at Don Lucas Reserve, Cronulla. The 80km, 60km and 40km events will start between 6:50am-8:15am from Bicentennial Park, Olympic Park via Cooks River Cycleway; Cahill Park, Wolli Creek; Bonna Point Reserve, Kurnell (80km and 60km) and onto Don Lucas Reserve, Cronulla. The 20km event will start between 8:00am-9:30am from Cahill Park, Wolli Creek and finish at Don Lucas Reserve, Cronulla.

Cut-offs will be in place for participants at select locations along all four ride routes. The ride will finish at 1:00pm at Don Lucas Reserve, Cronulla. Festivities will continue in the Reserve area.

Patrons attending Gear Up Girl Challenge 2018 are advised to use public transport. For timetables, maps and trip planning visit www.transportnsw.info.

Planned Trackworks Works by Sydney Trains will occur between Saturday 10 and Sunday 11 March (weekend) and includes the following:

- **T4 Eastern Suburbs & Illawarra Line**
 - Buses replace trains between Waterfall, Cronulla and Central.

Hence, Cronulla Station will be closed due to these trackworks and bikes cannot be taken onto Rail Replacement Buses, which will impact return trips from Don Lucas Reserve, Cronulla and participants travel plans by train. The nearest operating Railway Stations will be Wolli Creek to Central via the T8 Airport Line or Tempe to Central via the T8 South Line.

EVENT CONTACTS

Name: Gear Up Girl 2017
Website: <http://www.gearupgirl.com.au/>
Name: Bicycle NSW
Email: info@gearupgirl.com.au
Contact Number (02) 9704 0800

ROAD CLOSURES

Road closures affect both directions unless stated otherwise. Roads will be progressively reopen after cleaning

ARNCLIFFE/WOLLI CREEK

FROM 7:00AM TO 10:45PM

Levey Street*	between Gertrude Street & Innesdale Road	Both Directions
Innesdale Road	between Levey Street & Marsh Street	Both Directions

* Local access for both residents and businesses.

LANE CLOSURES

ARNCLIFFE/WOLLI CREEK

FROM 7:00AM TO 10:45PM

Marsh Street	right turn lane on Marsh Street into Innesdale Road
--------------	---

SPEED ZONE AUTHORISATION

CARINGBAH/WOOLLOOWARE/GREENHILLS BEACH/KURNELL

FROM 6:00AM TO 13:30PM

Captain Cook Drive	between Gannons Road & Sir Joseph Banks Drive	Eastbound
Captain Cook Drive	between Sir Joseph Banks Drive & Trinity Street	Westbound

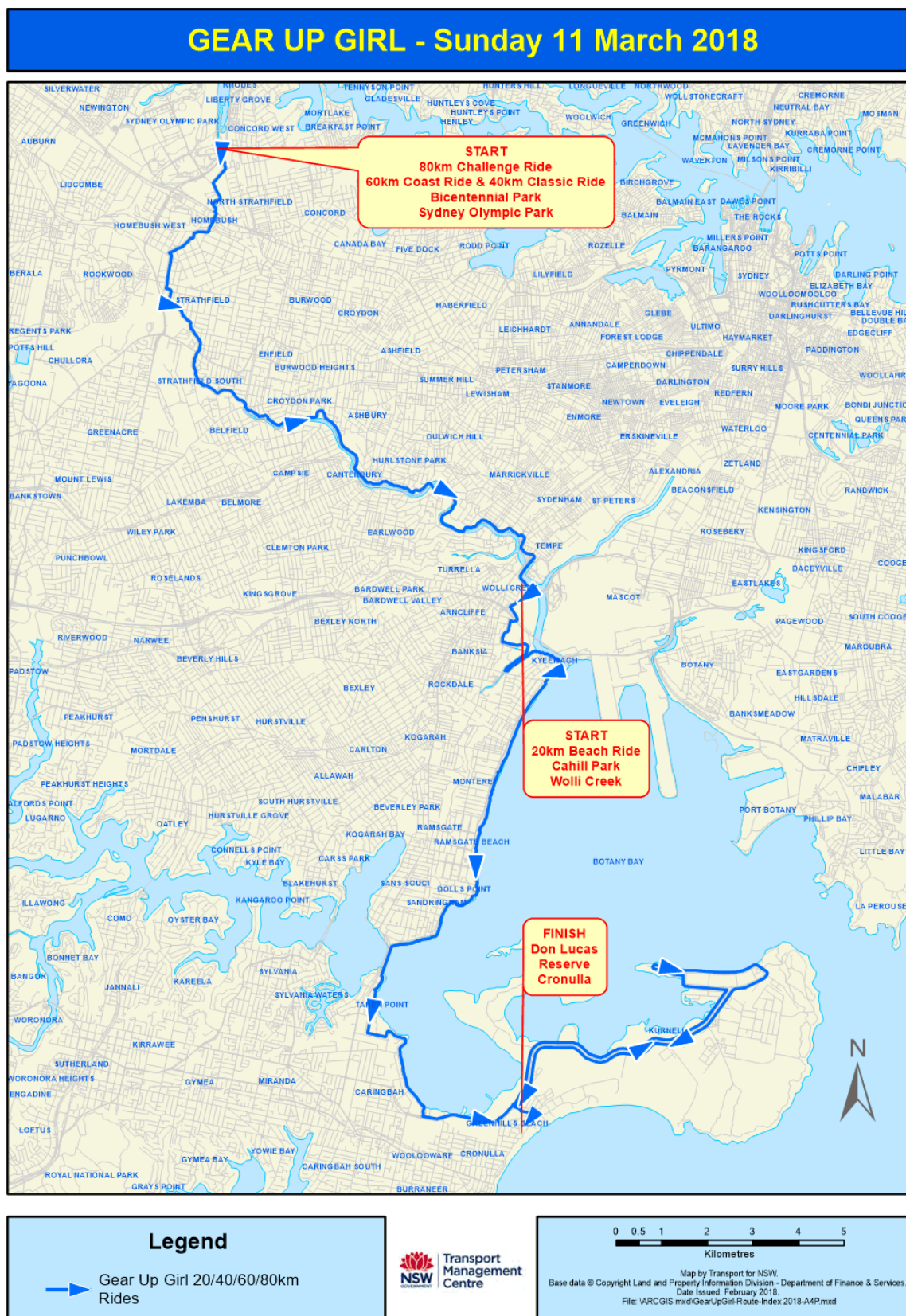

GEAR UP GIRL - Sunday 11 March 2018 Sydney Olympic Park to Homebush West

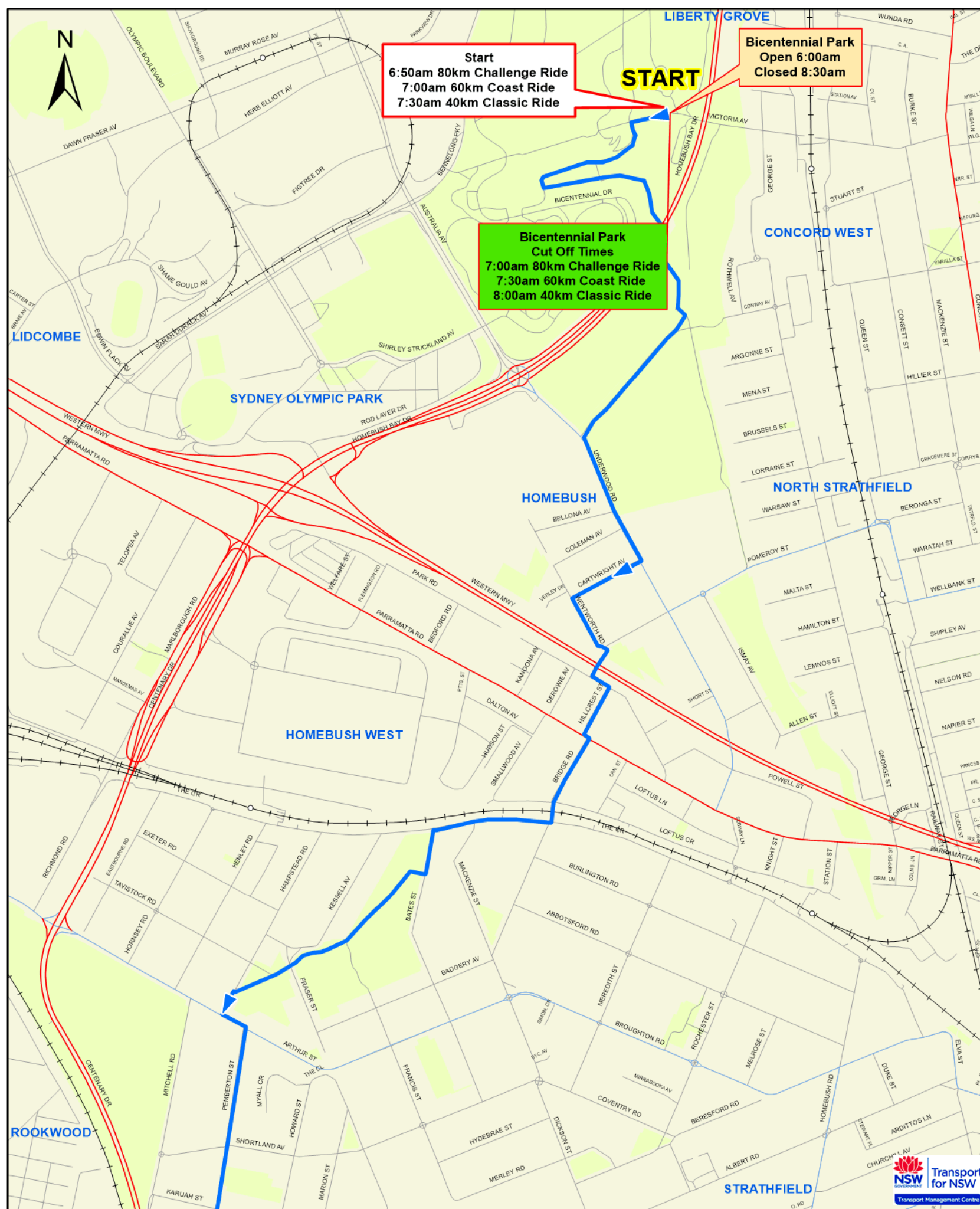

GEAR UP GIRL - Sunday 11 March 2018 Homebush West to Croydon Park

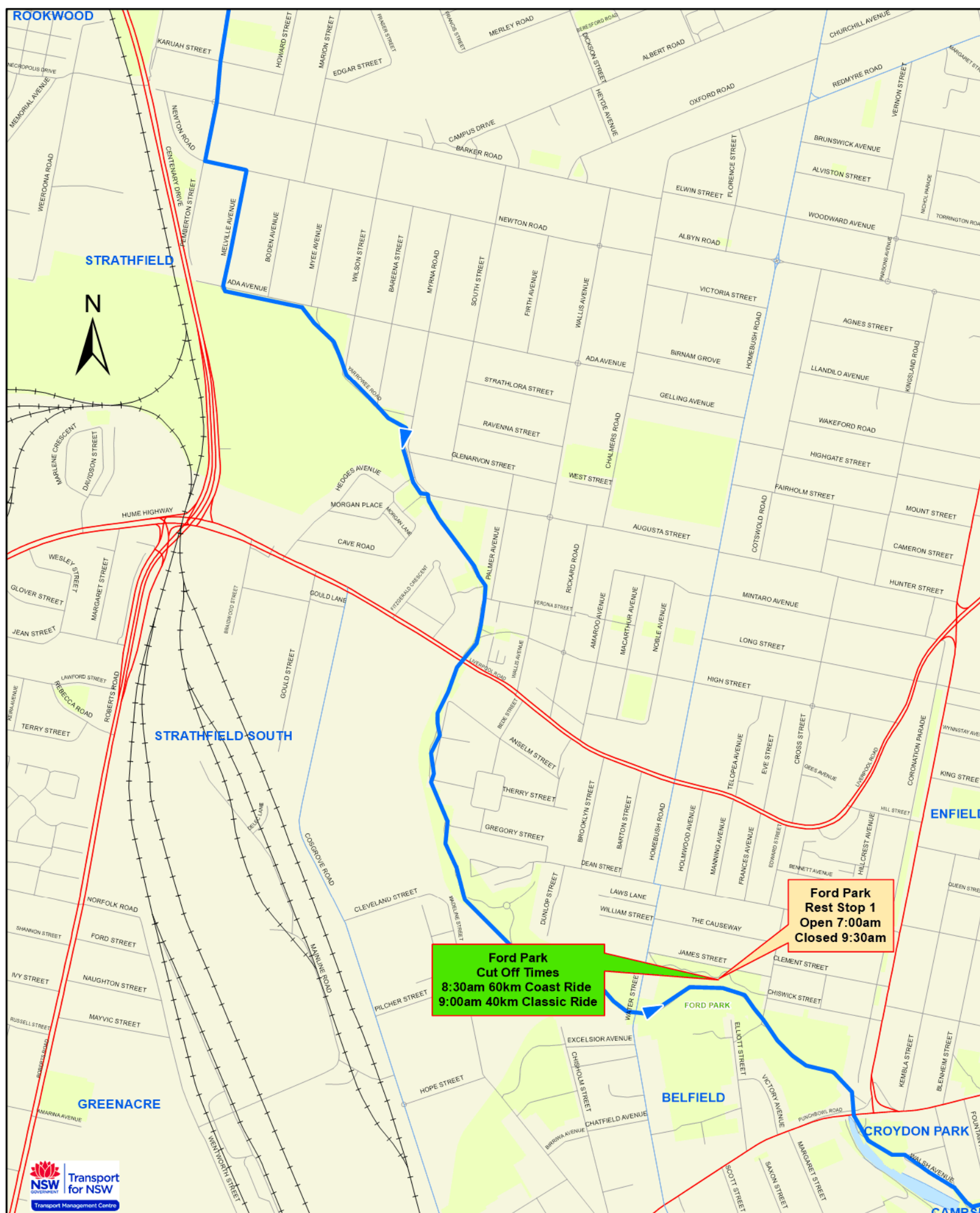

Legend

- ➡ Gear Up Girl 40/60/80km Rides
- State Roads
- Regional Roads
- Local Roads

0 0.1 0.2 0.4 0.6 0.8 1
Kilometres

Map by Transport for NSW.
Base data © Copyright Land and Property Information Division - Department of Finance & Services.
Date Issued: January 2018.
File: \ARCGIS mxd\GearUpGirl-Route_2-2018-A3P.mxd

GEAR UP GIRL - Sunday 11 March 2018
Croydon Park



Legend

	Gear Up Girl 40/60/80km Rides		Regional Roads
	State Roads		Local Roads



0 0.1 0.2 0.4 0.6 0.8 1
Kilometres

Map by Transport for NSW.
Base data © Copyright Land and Property Information Division - Department of Finance & Services.
Date Issued: January 2018.
File: \ARCGIS mxd\GearUpGirl-Route_3-2018-A3.mxd

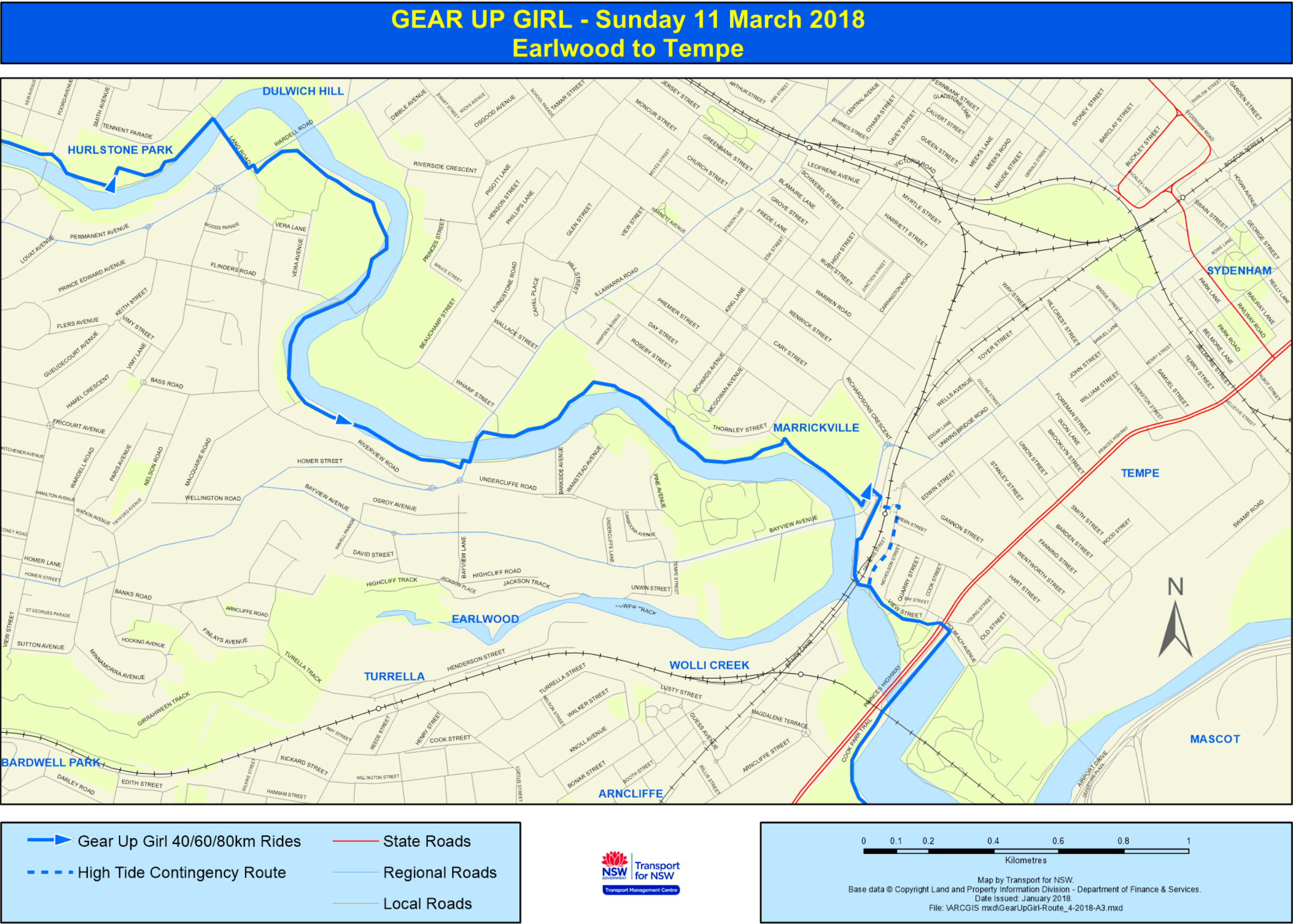

GEAR UP GIRL - Sunday 11 March 2018 Arncliffe



GEAR UP GIRL - Sunday 11 March 2018 Kogarah

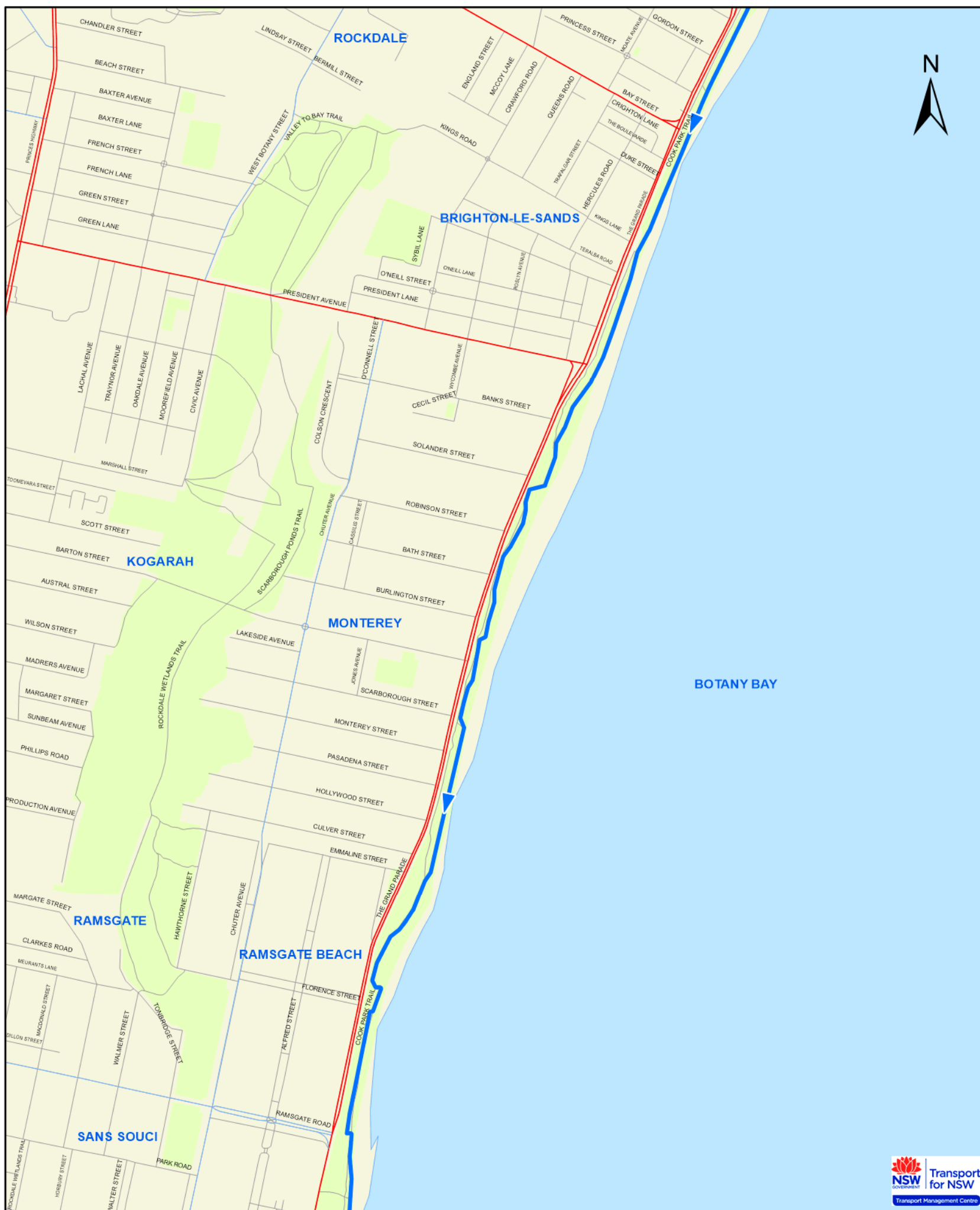

Legend

- ➡ Gear Up Girl 20/40/60/80km Rides
- State Roads
- Regional Roads
- Local Roads

0 0.1 0.2 0.4 0.6 0.8 1
Kilometres

Map by Transport for NSW.
Base data © Copyright Land and Property Information Division - Department of Finance & Services.
Date issued: January 2018.
File: \ARCGIS mxdGearUpGirl-Route_6-2018-A3P.mxd

GEAR UP GIRL - Sunday 11 March 2018 Sandringham

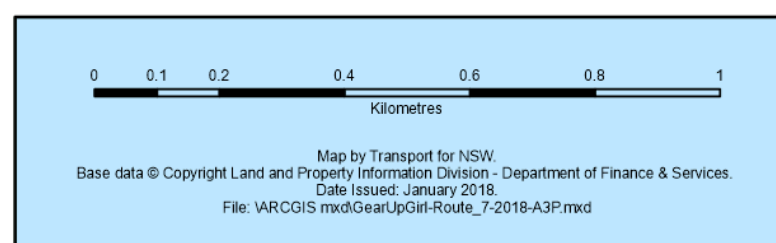

GEAR UP GIRL - Sunday 11 March 2018 Taren Point

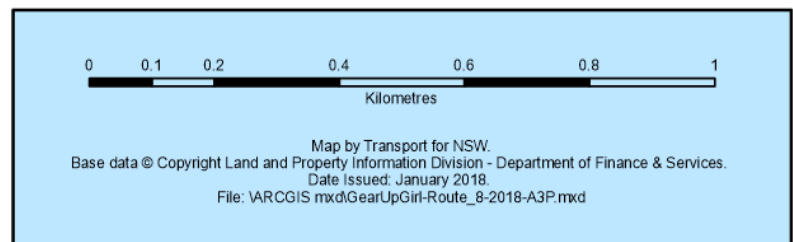
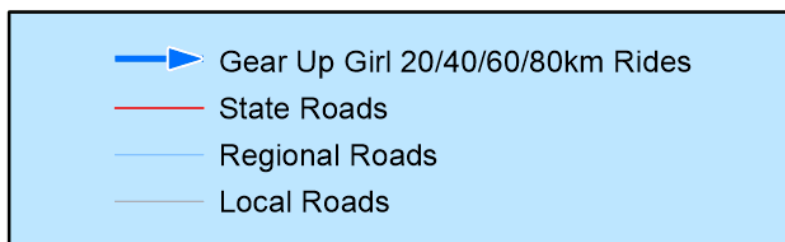

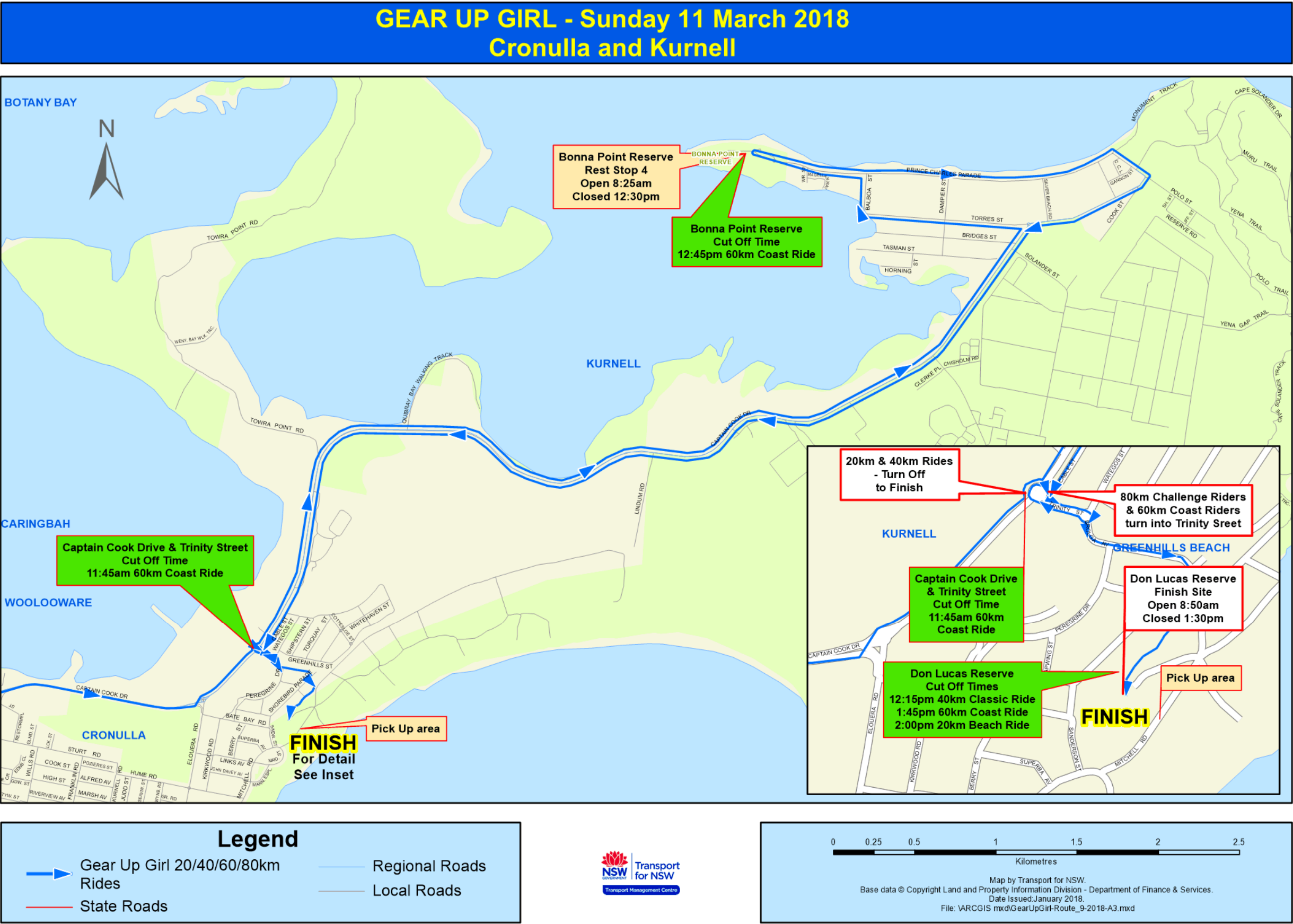



Ref: D/2018/28473

12th January, 2018.

Ms Jane ROBERTSON
Bicycle NSW
PO Box 293
CONCORD WEST NSW 2138

2018 Gear Up Girl

Dear Ms Robertson

I refer to your application to conduct the 2018 Gear Up Girl raising funds for the Heart Foundation on Sunday 11th March, 2018.

In principle, the New South Wales Police Force does not sanction the conduct of this type of event on the State's Highways and major road systems. There are inherent risk factors which directly impact on the safety of those involved and other road users. These risk factors include:

- high speeds,
- high traffic volumes,
- long lengths of unformed/gravel road shoulders,
- horizontal and vertical site distance restrictions,
- narrow lane widths, and
- large heavy vehicles, long distance coaches and B-Double movements on all major roads throughout New South Wales.

The New South Wales Police Force has no official objections to your present application, provided the event is conducted in accordance with the attached lists of conditions. Departure from these conditions may result in police terminating the event and thereby requiring participants to comply with the normal provisions of the Road Transport Legislation.

You are to ensure that all relevant Councils and other land holders such as Sydney Olympic Park Authority are fully informed of your proposal and approve of this event.

I wish you all the best and trust you will have a safe and enjoyable event.

Amanda Calder
Chief Inspector

State Planning Unit

Police Transport & Public Safety Command

Level 5, Sydney Police Centre, 151-241 Goulburn Street, Surry Hills, NSW, 2010

Telephone 02 9265 4720 Facsimile 02 9265 4559 ENet 54720 EFax 54559 TTY 9211 3776 (Hearing/Speech impaired)

ABN 43 408 613 180

NSW POLICE FORCE RECRUITING NOW 1800 222 122
WWW.POLICE.NSW.GOV.AU/RECRUITMENT

2018 GEAR UP GIRL

11th MARCH 2018

GENERAL CONDITIONS

1. Provisions of the Road Transport Legislation to be observed at all times.
2. Any person competing in, organising or supporting competitors, or in any other manner connected with the event, **must obey any reasonable directions given by a member of the NSW Police Force.**
3. **A member of the New South Wales Police Force has the authority to delay, halt or cancel the event at any stage in the interests of road safety or the safety of the community.**
4. **Any directions issued by the Roads and Maritime Services must be promptly obeyed.**
5. The event is to be conducted in accordance with the timing and route supplied and approved by Police.
6. The event is to be conducted within the nominated dates of the event.
7. **Any breach of these conditions may result in the event being halted by the NSW Police.**

ORGANISERS

8. Organisers, officials and participants are to take all reasonable measures to reduce obstruction to pedestrians or vehicles during the course of the event.
9. **Organisers must provide sufficient marshals to control participants in the event. The number of volunteer marshals must be at a minimum the number as indicated in the approved Traffic Control Plans.**
10. The Organiser is to ensure that all participants and event marshals are adequately briefed as to their roles and responsibilities. The event organiser is to ensure Police are in attendance at the marshal briefing prior to the event.

11. The Organiser is to maintain contact with the Miranda Local Area Command with respect to the policing requirements for event.

PARTICIPANTS

12. Participants are not permitted on a road during periods of poor visibility due to inclement weather or fog, or where there is insufficient daylight to render a person dressed in dark clothing to be discernible at a distance of 100 metres.
13. Participants shall keep to the extreme left-hand side of the carriageway at all times.
14. Participants to obey traffic lights and comply with "STOP" and "GIVE WAY" signs during the event.
15. Participants are to wear approved helmets in compliance with the Road Transport Legislation.
16. Participants **MUST** wear suitable reflective clothing when cycling upon a road.
17. The total number of participants in the **Challenge Ride (80km) must not exceed 100, Coast Ride (60km) must not exceed 400, Classic Ride (40km) must not exceed 400, and Beach Ride (20) must not exceed 350.**
18. No participant is to wear headphones or similar devices whilst participating in the event, and shall remain alert of their surroundings and attentive to instructions given by organisers or other authorities.

COMMUNICATION

19. Communication equipment is to be provided to ensure efficient and effective control of the event. Communication is to be maintained between marshals, the traffic control company, event organisers and Police at all times during the course of the event.

SPECIAL CONDITIONS.

20. The organiser **MUST** monitor road traffic. In the event of traffic built up, the cyclists **MUST** clear the road and allow traffic to pass.
21. The organiser **MUST** contact **Sergeant Grant KIRK at Sutherland Local Area Command on 9542 0899** to engage police in accordance with the NSWPF Cost Recovery and User Charges Policy. The total number of police engaged will be in accordance with the approved Traffic Management Plan/event risk management plan as negotiated

between the parties. These officers will be deployed to various locations to assist with traffic management along the route.

22. Any cyclists participating in the event that falls behind the last vehicle is to either be uplifted to the next available section or **MUST REMOVE THEMSELVES FROM THE EVENT** by removing their identifying bib or branding. That cyclist will then comply with all road rules and become a normal cyclist not connected with the event.
23. The organiser is to ensure that all relevant Councils and other land holders such as Sydney Olympic Park Authority are fully informed and have provided written approval for the event.
24. Prior to the commencement of the event the organiser is to contact the Transport Management Centre on 1800 679 782 and advise the nature of the event and the days route.

The letter of authority and General Conditions MUST be carried at all times during the conduct of this event and be capable of being produced, if required, to a member of the NSW Police Force or an Officer of the Roads and Maritime Services of NSW.

Amanda Calder
Chief Inspector
Traffic & Transport Operations
Major Events & Incidents Group
9265 4720

DATE OF ISSUE: 12 January, 2018.

2018 Gear Up Girl – Estimated Schedule of NSW Police Force Personnel

Sunday 11th March 2018

TCP #	Intersection	Police	Times on point	Suggested Shift Times	Sequence
TCP 17	Marsh Street and Innesdale Road	2	0700 – 1100	0630 – 1130	
TCP 24	Captain Cook Drive and Elouera Road	1	0800 – 1300	0730 – 1330	Plus Police Vehicle
TCP 25	Captain Cook Drive and Trinity Street	2	0800 - 1300	0730 - 1330	
TCP 27	Captain Cook Drive / Elouera Road to Torres Street Kurnell.	2	0830 – 1330	0800 - 1400	Plus 2 x HWP Police Vehicles
TCP 28	Captain Cook Drive and Torres Street	1	0815 – 1300	0730 - 1330	
RELIEF		1	0730 - 1300	0630 – 1330	Plus Police Vehicle
SUPERVISOR		1		0630 – 1400	Plus Police Vehicle

Bayside Traffic Committee

7/02/2018

Item No	BTC18.007
Subject	Geeves Avenue west of Princes Highway, Rockdale - proposed convert P5 minute parking to P15 Minute
Report by	Pintara Lay, Coordinator Traffic and Road Safety
File	SC18/2
Electorate	Rockdale Electorate, Rockdale Ward, TRIM18/685

Summary

Council has received a request to convert the existing P5 minute parking to P15 minute along the southern kerb line of Geeves Avenue, west of Princes Highway, Rockdale.

Officer Recommendation

That approval be given to the proposed conversion of P5 Minute parking limit to P15 Min parking limit along the southern kerb line of Geeves Avenue west of Princes Hwy, Rockdale, as follows:

- 1 From 0.0m to a point 10m – Retain existing ‘No Stopping’ zone
 - 2 From 10.0m to a point 19m – proposed ‘P15 minutes, 8:30 am – 6 pm, Mon – Fri and 8.30 am -12.30 pm, Sat’ restriction
 - 3 From 19m to 26m – retain existing ‘1P, 8:30 am – 6 pm, Mon – Fri and 8.30 am -12.30 pm, Sat’ restriction
 - 4 From 26m westward – retain existing ‘No Stopping’ restriction
-

Background

Currently, along the southern kerb line of Geeves Avenue west of Princes Highway, is signposted with P5 minute and 1P parking restrictions.

The P5 Minute parking zone was installed a number of years ago to provide a set down and pick up area for train passengers, on the eastern side of Rockdale Railway Station. A public telephone box is also located near the short term parking.

Council has received a request to convert it from P5 minute parking limit to P15 minute limit to cater for local business shoppers need. There are seven (7) spaces in Rockdale Commuter Car Park in Geeves Avenue which have been signposted as P5 Minutes. These spaces are available as a ‘Pick Up and Set Down Area’.

It is recommended that the existing P5 Minute parking limit in Geeves Avenue be converted to P15 Minutes as shown in the attached drawing TC1422.

Financial Implications

Not applicable	<input type="checkbox"/>	
Included in existing approved budget	<input checked="" type="checkbox"/>	Block grant for traffic facilities on local streets
Additional funds required	<input type="checkbox"/>	<<Enter comment if required or delete>>

Community Engagement

Affected local business people to be advised of Council's decision.

Attachments

- 1 Geeves Avenue west of Princes Hwy - proposed Convert P5min to P15min TC1422 drawing
- 2 Geeves Avenue picture from Google Map

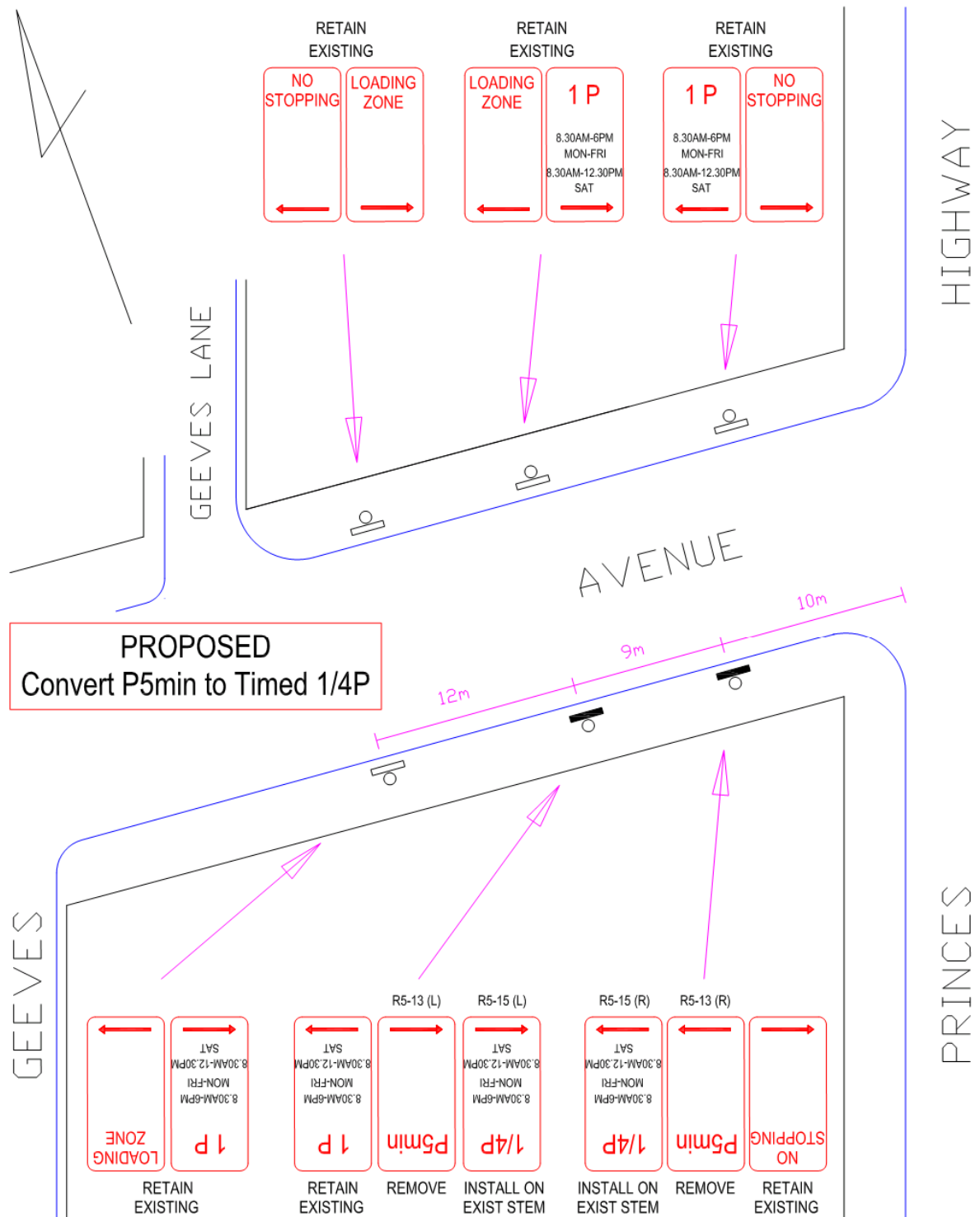

G/TS/T&RS/JM/Geeves Ave Convert P5 to P15 TC1422



Bayside Traffic Committee

7/02/2018

Item No	BTC18.008
Subject	Haran Street at the side of 133 O'Riordon Street, Mascot - Proposed Works Zone
Report by	Agasteena Patel, Traffic Engineer
File	SC18/2
Electorate	Heffron Electorate, Mascot Ward

Summary

Council has received a request from the property owner at 133 O'Riordon Street, Mascot for the provision of 20m 'Works Zone' signs along their frontage in Haran Street to facilitate the demolition of existing building at the site for a period of 13 weeks.

Officer Recommendation

- 1 That approval be given to the installation of 20m of 'Works Zone 7.30 am- 5.30 pm, Mon – Fri and 7.30 am – 3.30 pm, Sat' restriction in Haran Street outside 133 O'Riordon Street, Mascot, for a duration of 13 weeks, subject to relevant conditions.
- 2 That parking restrictions on the opposite side of Haran Street will not be amended to facilitate access to this Works Zone.

Background

It is often recommended that kerb side parking, surrounding a large construction site, be kept clear of parked vehicles to allow access for heavy plant and vehicles and the removal/delivery of associated materials.

To facilitate construction activity it is recommended that a works zone be provided.

In accordance with Road Rules 2014, Rule 181 states that:



Works zone

This sign means that a driver must not stop in a works zone unless the driver's vehicle is actually engaged in construction work in or near the zone. Any vehicle may stop to pick up or set down passengers.

Hours of operation; '7.30 am – 5.30 pm, Mon – Fri and 7.30 am – 3.30 pm, Sat' will apply to this works zone.

The locality of the existing and proposed parking restrictions in Haran Street, is shown in the attached documents.

Financial Implications

Not applicable	<input type="checkbox"/>	
Included in existing approved budget	<input checked="" type="checkbox"/>	Developers will pay for the installation and removal of Works Zone signage
Additional funds required	<input type="checkbox"/>	

Community Engagement

Not applicable

Attachments

Haran St at the side of 133 O'Riordan Street - proposed works zone map

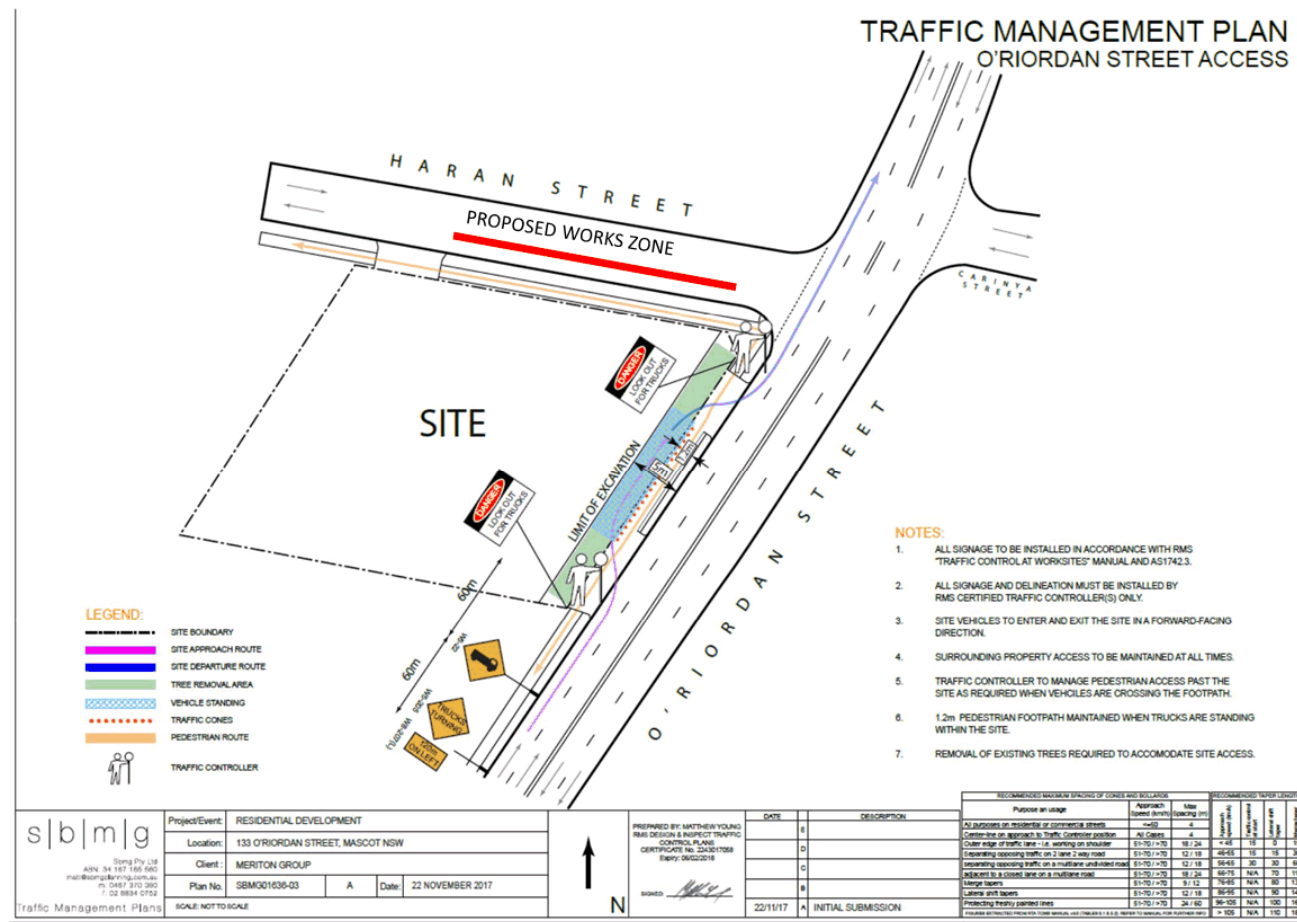

Bayside Traffic Committee

7/02/2018

Item No	BTC18.009
Subject	Julian Close, new road, south of Corish Circle, Hillsdale - Proposed 'No Stopping' restriction
Report by	Pintara Lay, Coordinator Traffic and Road Safety
File	SC18/2
Electorate	Maroubra Electorate, Bay Botany Ward

Summary

To consider a request to provide 'No Stopping' restrictions on a newly created road, 'Julian Close', south of Corish Circle, Hillsdale, as part of conditions of consent of the new subdivision.

Officer Recommendation

That approval be given to the installation of 'No Stopping' restrictions on both sides of Julian Close south of Corish Circle, Hillsdale as follows:

- 1 from 0m to 45m – proposed 'No Stopping' restriction, past Qenos Chemical Plant's driveway
 - 2 from 45m southward – retain existing parking
-

Background

As a result of the new subdivision in Hillsdale, a new road was created and completed in November 2017.

The new road is called as 'Julian Close' which is bounded by:

- Corish Circle to the north;
- a cul de sac end to the south;
- Denison Street to the east and private land; and,
- Qenos Chemical Plant, to the west.

It has been used as a public road and it is recommended that parking restrictions be provided for emergency access to private land and the new subdivision.

The locality, of the new road, Julian Close, and the proposed 'No Stopping' restriction, is shown in the attached drawing.

Financial Implications

Not applicable



Included in existing approved budget	<input checked="" type="checkbox"/>	Developers of new subdivisions will fund the installation of No Stopping signs and stems
Additional funds required	<input type="checkbox"/>	<<Enter comment if required or delete>>

Community Engagement

Affected businesses in the area be advised of Council decision

Attachments

- 1 Julian Close Proposed No Stopping Map
- 2 Julian Close Corish Circle and Denison Street Map

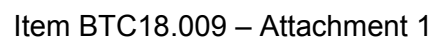



Bayside Traffic Committee

7/02/2018

Item No	BTC18.010
Subject	King Street, Mascot - Proposed Works Zone for property at 904 Botany Road
Report by	Agasteena Patel, Traffic Engineer
File	SC18/2
Electorate	Heffron Electorate, Mascot Ward

Summary

Council has received a request from the builders at 904 Botany Road, Mascot for the provision of 14.5m 'Works Zone' signs along King Street frontage to facilitate the construction of mixed use development for a duration of 26 weeks.

Officer Recommendation

- 1 That approval be given to the installation of 14.5m of 'Works Zone 7.30 am- 5.30 pm, Mon – Fri and 7.30 am- 3.30 pm, Sat' restriction in King Street outside 904 Botany Road, Mascot, for a duration of 26 weeks, subject to relevant conditions.
- 2 That existing 1/2P parking restrictions be restored upon completion of 'Works Zone' restrictions after 26 weeks.

Background

It is often recommended that kerb side parking, surrounding a large construction site, be kept clear of parked vehicles to allow access for heavy plant and vehicles and the removal/delivery of associated materials.

To facilitate construction activity, it is recommended that a works zone be provided.

In accordance with Road Rules 2014, Rule 181 states that:



Works zone

This sign means that a driver must not stop in a works zone unless the driver's vehicle is actually engaged in construction work in or near the zone. Any vehicle may stop to pick up or set down passengers.

Hours of operation; '7.30 am – 5.30 pm, Mon – Fri and 7.30 am – 3.30 pm, Sat' will apply to this works zone.

The locality of the existing and proposed parking restrictions in King Street, is shown in the attached documents.

Financial Implications

Not applicable	<input type="checkbox"/>	
Included in existing approved budget	<input checked="" type="checkbox"/>	Developers will pay for the installation and removal of Works Zone signage
Additional funds required	<input type="checkbox"/>	

Community Engagement

Not applicable

Attachments

King Street Works Zone

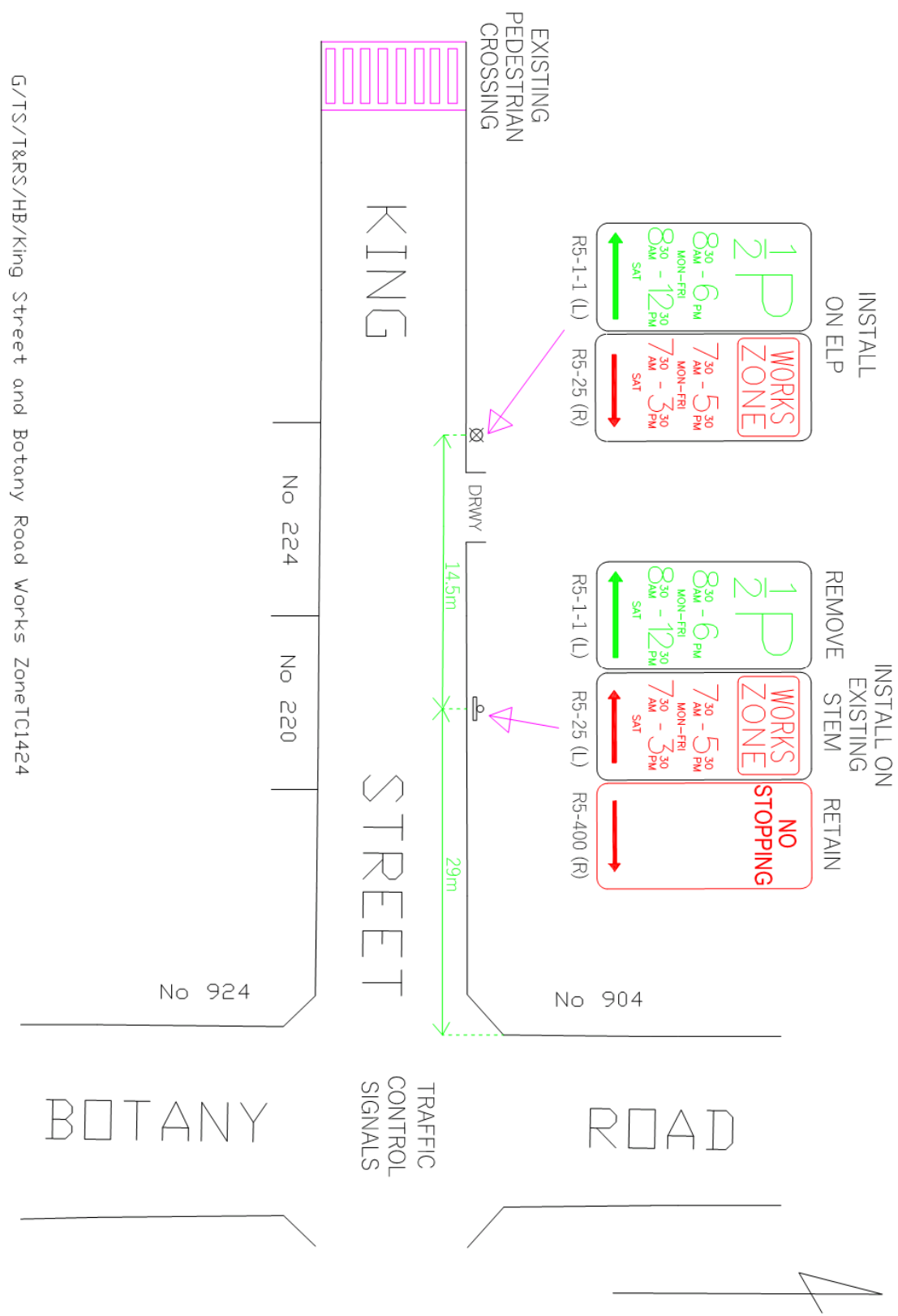

G/TS/T&RS/HB/King Street and Botany Road Works ZoneT1424

Bayside Traffic Committee

7/02/2018

Item No	BTC18.011
Subject	King Street eastern approach to George Street, Rockdale - proposed change GIVE WAY to STOP
Report by	Pintara Lay, Coordinator Traffic and Road Safety
File	SC18/2
Electorate	Rockdale Electorate and Rockdale Ward

Summary

Council has received a request for the provision of additional traffic safety measures at the intersection of George Street and King Street, Rockdale.

Officer Recommendation

That approval be given to the proposed conversion of the existing Give Way to Stop priority control on the eastern approach of King Street to George Street, Rockdale.

Background

Currently, the intersection of George Street and King Street is a four-leg junction where King Street approaches are controlled by 'Give Way' priority controls.

A marked footcrossing has been provided on the northern approach of George Street and a pedestrian refuge island on the western approach of King Street.

The northern approach of George Street is on a down-hill slope toward the intersection.

The sight distance of the eastern approach of King Street is partially obstructed by a big tree and the electricity power pole. It is difficult to see the on-coming from George Street northern approach.

One injury crash was reported in the period of five years, ending on 31 December 2016, involving a vehicle from the King Street eastern approach and the cross traffic from the George Street approach.

It is recommended to change the priority control on the King Street approach from GIVE WAY to STOP but retain the existing Give way on the western approach of King Street as shown in the attached drawing TC1426.

Financial Implications

Not applicable	<input type="checkbox"/>	
Included in existing approved budget	<input checked="" type="checkbox"/>	Block grant for traffic facilities on local streets

Additional funds required

☐

<<Enter comment if required or delete>>

Community Engagement

Affected residents be advised of Council's decision.

Attachments

- 1 King Street and George Street proposed change GIVE WAY to STOP - TC1426 drawing
- 2 King Street and George Street aerial map

GTS/RSR/Electronic Drawing/Final Drawing/King St and George St Conversion of Give Way to Stop TC1426

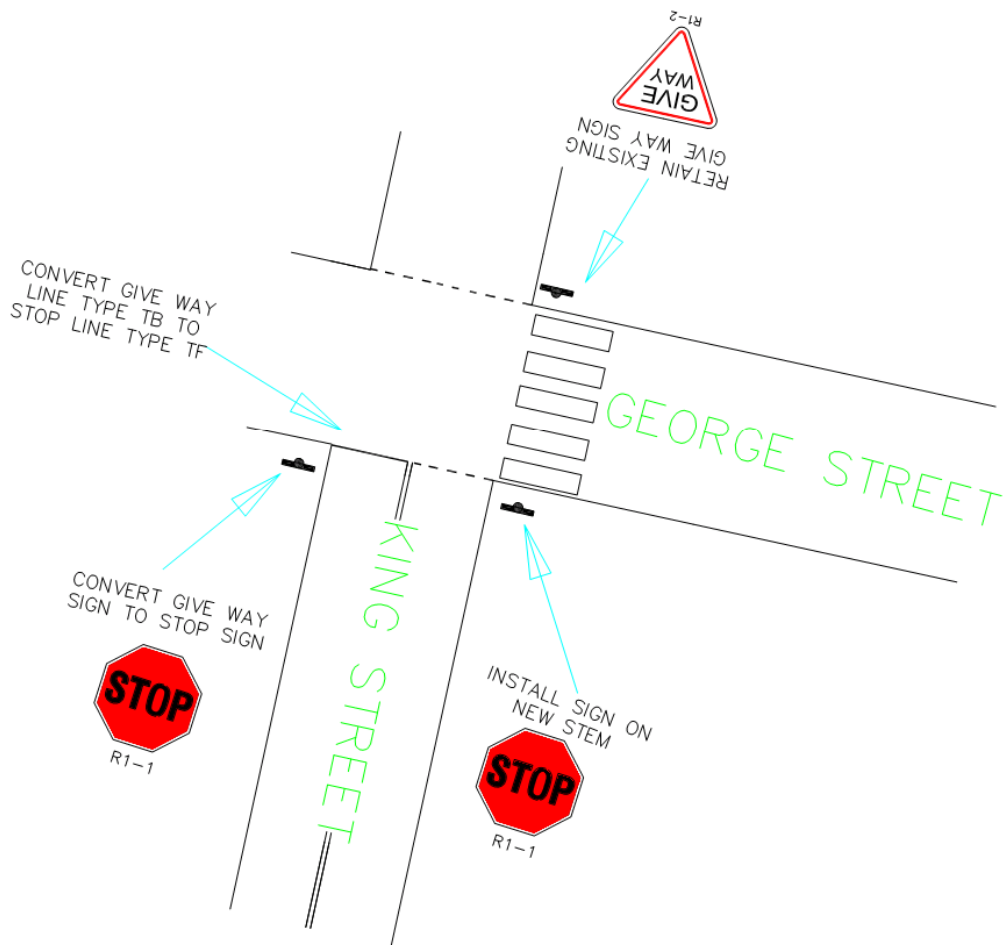

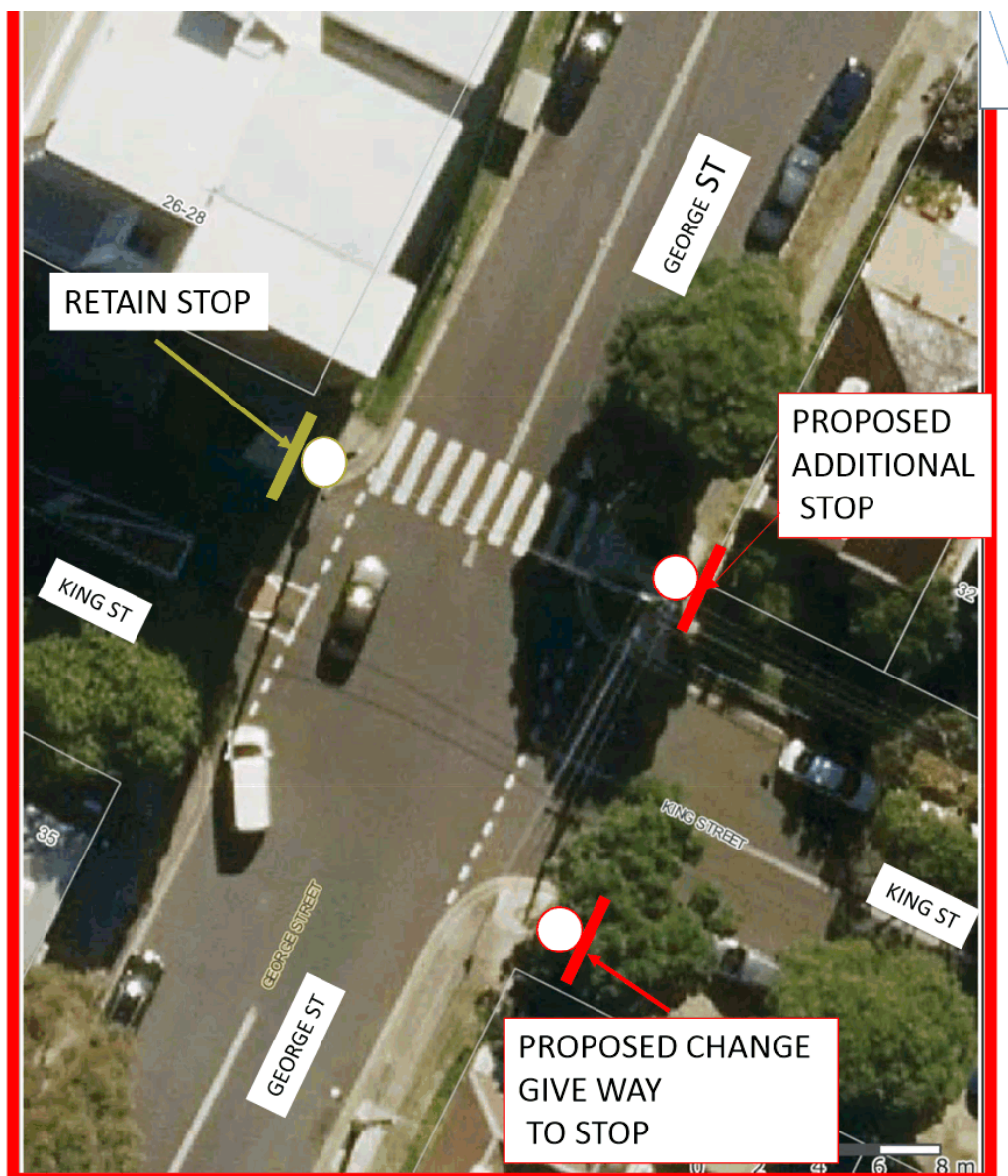

Bayside Traffic Committee

7/02/2018

Item No	BTC18.012
Subject	Laycock Street, and Donnan Street near Stoney Creek Road, Bexley- proposed removal of two bus zones and installation of a bus zone respectively
Report by	Pintara Lay, Coordinator Traffic and Road Safety
File	SC18/2
Electorate	Kogarah Electorate, Bexley Ward

Summary

Council has received a request from Punchbowl Bus Company to remove two bus zones from Laycock Street, Bexley North and the installation of a bus zone in Donnan Street due to the change to route 446.

Officer Recommendation

That approval be given to the removal of two bus zones on both sides of Laycock Street, in front of and opposite Laycock Hannah Reserve north of Stoney Creek Road, Bexley.

Background

Punchbowl Bus Company (PBC) advises that following changes to route 446, the old route along Laycock Street no longer operates via Alston Street, Laycock Street, Stoney Creek Road or Henderson Road.

Instead it will be operating direct via Preddy's Road between New Illawarra Road and Donnan Street. As a result, PBC requests that bus zones located in Laycock Street near Stoney Creek Road, Bexley Road be removed. They are located at the following locations:

- 1 Laycock Street, side of 210 Stoney Creek, opposite Hannah Laycock Reserve
- 2 Laycock Street, side of Hanna Laycock Reserve.

PBC requested the installation of a bus stop in Donnan Street for the new bus route. A bus stop can be installed by the operator under delegation.

The maps showing the existing and new routes for bus route 446 are attached.

Financial Implications

Not applicable	<input type="checkbox"/>	
Included in existing approved budget	<input checked="" type="checkbox"/>	Block Grant for traffic facilities on local streets
Additional funds required	<input type="checkbox"/>	<<Enter comment if required or delete>>

Community Engagement

Punchbowl Bus Company to consult affected residents before the installation of a new bus zone in Donnan Street, Bexley

Attachments

- 1 New Bus Route 446 Bexley North map
- 2 Existing bus Route 446 Map

Route 446

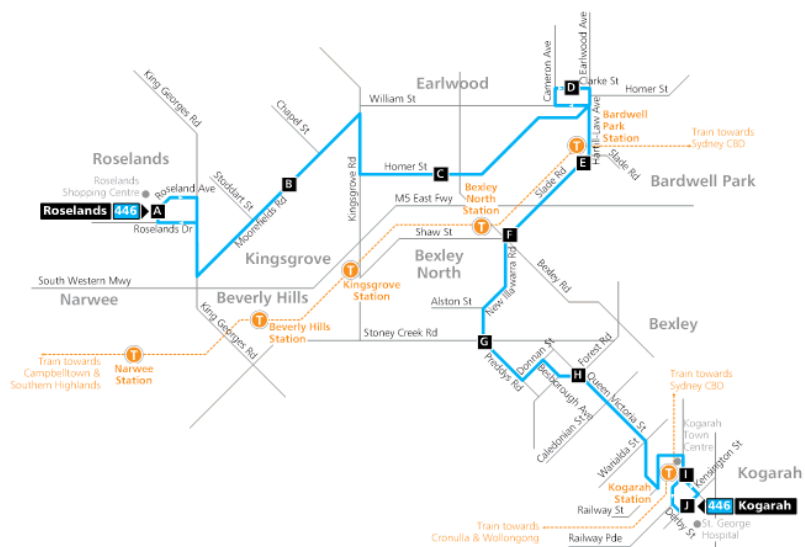

Legend

- Bus route
- 446 Bus route number
- A Timing point
- T— Train line/station

Diagrammatic Map
Not to Scale



Existing Bus Route Map for Route 446

Bayside Traffic Committee

7/02/2018

Item No	BTC18.013
Subject	Moate Avenue, Brighton Le Sands - Detailed Design Drawings for proposed roundabouts at the intersections with Henson Street and Sellwood Street
Report by	Agasteena Patel, Traffic Engineer
File	SC18/2
Electorate	Rockdale

Summary

This report provides detailed design drawings for traffic calming scheme in Moate Avenue between Henson Street and Sellwood Street, Brighton Le Sands, including two roundabouts and with associated 'No Stopping' restrictions and traffic islands at the intersections of Henson Street and Sellwood Street.

Officer Recommendation

- 1 That endorsement be given for the implementation of a roundabout at the intersection of Moate Avenue and Henson Street, Brighton Le Sands
 - 2 That endorsement be given for the implementation of a roundabout at the intersection of Moate Avenue and Sellwood Street, Brighton Le Sands
-

Background

Council at its meeting on 7 September 2016 considered recommendations of Rockdale Traffic Committee (item RT09), and resolved as follows:

"1 That approval be given to the installation of painting 10m double centre lines in all approaches of the intersection of Moate Avenue and Sellwood Street.

2 That in-principle support be given to the installation of additional traffic calming schemes in Moate Avenue between Henson Street and Sellwood Street, subject to the availability of funding:

** roundabout at the intersection of Moate Avenue and Sellwood Street, Brighton Le Sands with speed humps on all approaches.*

** roundabout at the intersection of Moate Avenue and Henson Street, Brighton Le Sands with speed humps on all approaches.*

3 That details of the proposed roundabouts be submitted to the Traffic Committee for further consideration when funding has been secured."

A grant submission had been lodged with Federal Government's Blackspot Program and NSW State Government's Safer Road under the 2017/2018 Program and Council has

successfully received a 100% grant of \$120,000 to fund the implementation of two roundabouts. Speed humps are not included in the current stage of works, and locations for devices are being reviewed.

Financial Implications

Not applicable	<input type="checkbox"/>	
Included in existing approved budget	<input checked="" type="checkbox"/>	100% funding under Nation Building Blackspot program RMS funding
Additional funds required	<input type="checkbox"/>	

Community Engagement

Notification will be carried out prior to commencement of works.

Attachments

- 1 Moate Avenue and Henson Street roundabout
- 2 Moate Avenue and Sellwood Street Roundabout

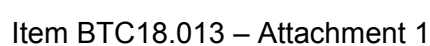

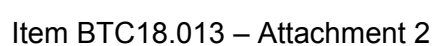

Bayside Traffic Committee

7/02/2018

Item No	BTC18.014
Subject	O'Neill Street and Wycombe Avenue, Brighton Le Sands - Proposed double barrier centre lines and supplementary 'Give Way' signs
Report by	Agasteena Patel, Traffic Engineer
File	SC18/2
Electorate	Rockdale Electorate and Botany Bay Ward

Summary

Council has received representation from residents for the provision of additional traffic safety measures at the intersection of O'Neill Street and Wycombe Avenue, Brighton Le Sands.

Officer Recommendation

That approval be given to the provision of additional traffic safety measures at the intersection of O'Neill Street and Wycombe Avenue, Brighton Le Sands:

- 1 Supplementary 'Give Way' priority control signs be installed in Wycombe Avenue on approaches to the intersection with O'Neill Street
 - 2 10m double centre lines on all four approaches at the intersection of O'Neill Street and Wycombe Avenue.
-

Background

O'Neill Street and Wycombe Avenue are both local streets with sign posted limit of 50km/h. They form a cross intersection with 'Give Way' priority control in O'Neill Street.

The crash data from Roads and Maritime Services for the latest five year period ending December 2016 indicate no reported crashes at this intersection. There have been reported cross-type intersection crashes at this intersection prior to that period.

The locality of existing and proposed traffic safety measures at the intersection of O'Neill Street and Wycombe Avenue, is shown in the attached drawing.

Financial Implications

Not applicable	<input type="checkbox"/>	
Included in existing approved budget	<input checked="" type="checkbox"/>	Block grant for traffic facilities on local streets
Additional funds required	<input type="checkbox"/>	

Community Engagement

Not required

Attachments

O'Neill Street and Wycombe Avenue, Brighton Le Sands

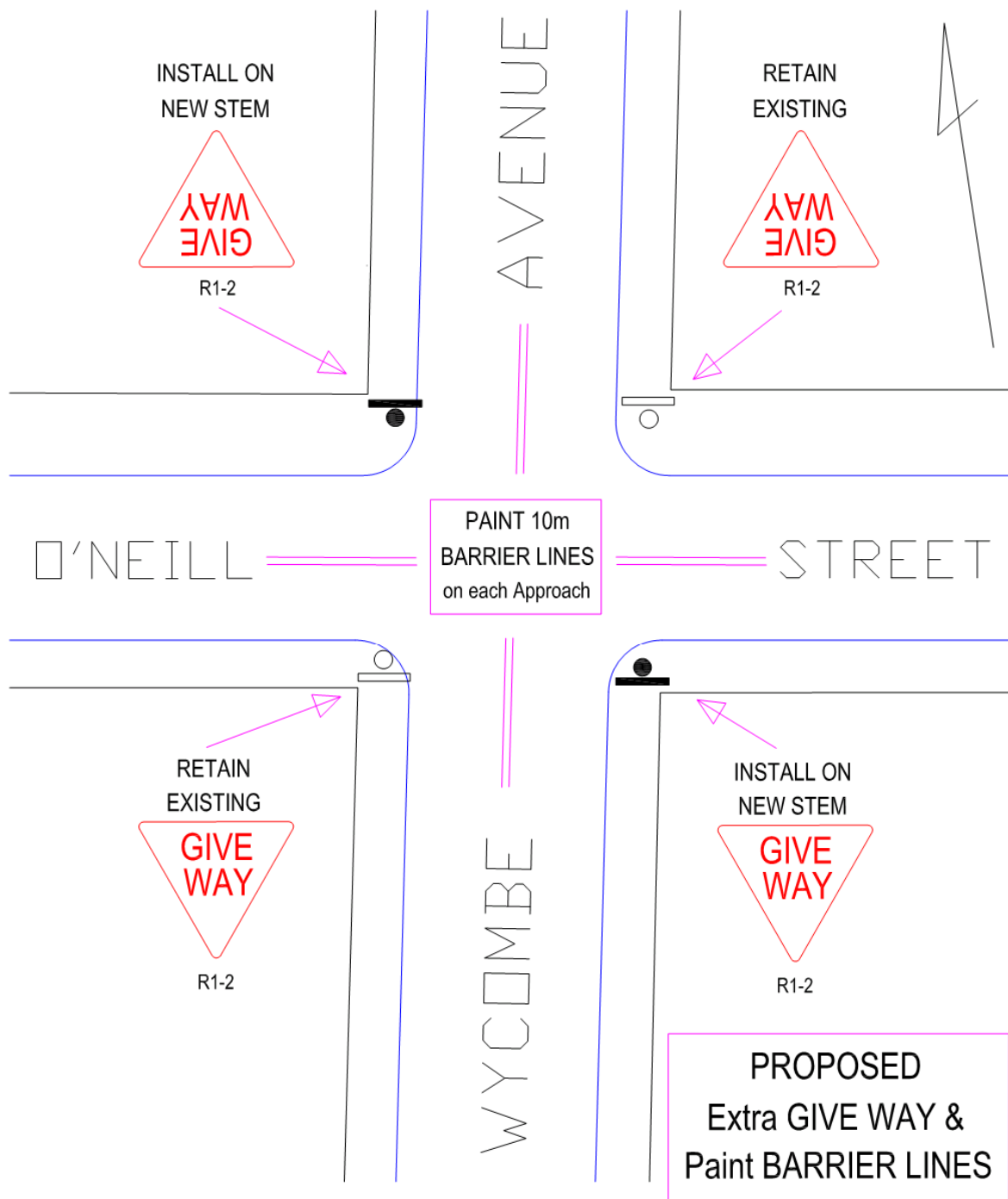

G/TS/T&RS/JM/O'Neill St Wycombe Ave GW CLines TC1420

Bayside Traffic Committee

7/02/2018

Item No	BTC18.015
Subject	Shaw Street, Bexley North - Proposed signposting of 'NST' and 'Bus Zone' restrictions
Report by	Agasteena Patel, Traffic Engineer
File	SC18/2
Electorate	Kogarah Electorate and Bexley Ward

Summary

To consider a request from a resident to address parking concerns in Shaw Street and install bus zone signs at the existing bus stop in Shaw Street, Bexley North

Officer Recommendation

That approval be given to the installation of the following parking restrictions along northern kerbline of Shaw Street, between Wolli Street and Berith Street:

- 1 From 0m to 11m – retain existing 'No Stopping' restriction (starting from Berith Street eastwards)
 - 2 From 11m to 26m - retain unrestricted parking
 - 3 From 26m to 56m - signposting 'Bus Zone 9 am - 4 pm Mon - Fri' restrictions at existing bus stop location
 - 4 From 56m to 74.5m - retain unrestricted parking
 - 5 From 74.5m to 84.5m – signpost 10m 'No Stopping' restriction
-

Background

Council had received a request from a resident to address the issue of illegal parking within the bus zone outside No. 149 Wolli Street along the Shaw Street frontage. State Transit Authority concurs with formalising the existing bus stop with time-limited 'Bus Zone' signposting.

The proposal aims to formalise existing parking restrictions that apply at the location, and will not result in loss of parking. The length of the proposed zone is 30m, consistent with Rule 195 of the Australian Road Rules that notes drivers must stop within 20m of the approach to a bus stop sign, nor 10m after the sign.

It is recommended that parking signs be installed as shown in the attached TC1425.

Financial Implications

Not applicable	<input type="checkbox"/>	
Included in existing approved budget	<input checked="" type="checkbox"/>	The installation of bus zone and no stopping zone will be funded through block grant for traffic facilities on local streets.
Additional funds required	<input type="checkbox"/>	

Community Engagement

Affected residents to be advised of Council's decision.

Attachments

Shaw Street Bus Zone and No Stopping

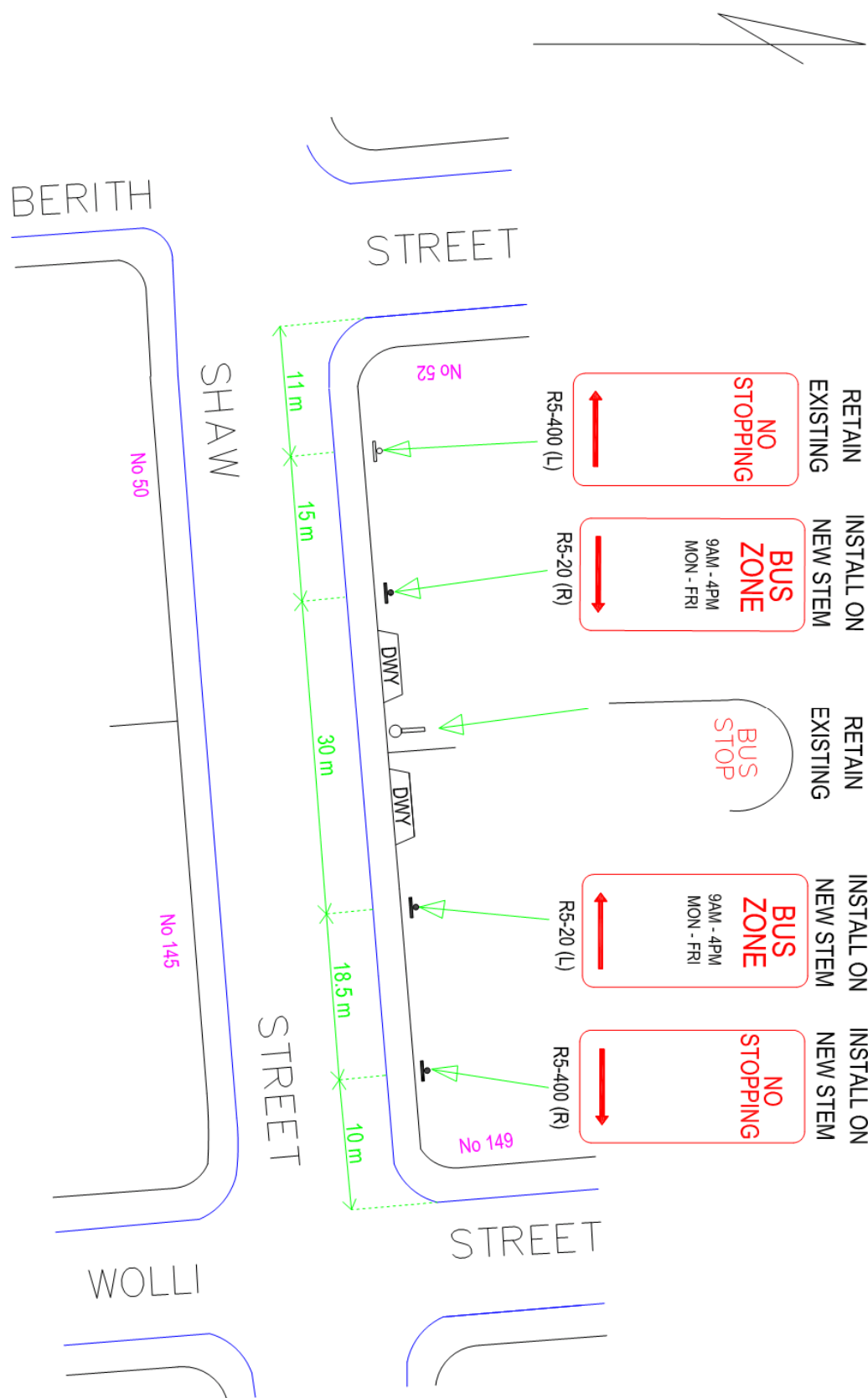

Bayside Traffic Committee

7/02/2018

Item No	BTC18.016
Subject	14 Trevelyan Street, Botany - Proposed 1P Parking
Report by	Pintara Lay, Coordinator Traffic and Road Safety
File	SC18/2
Electorate	Maroubra Electorate, Botany Bay Ward, DOC18/1830

Summary

Council has received a request for the provision of a disabled parking space in front of No. 14 Trevelyan Street, Botany.

As the alternative to the requested disabled parking zone at No. 14 Trevelyan Street, it is proposed that a 1P parking zone be provided.

Officer Recommendation

- 1 That the proposed 1P parking limit at 14 Trevelyan Street, Botany, be approved.
 - 2 That the applicant be advised that the 1P parking space is for all road users to use.
-

Background

Council has received an application for a disability parking zone adjacent to No. 14 Trevelyan Street, Botany, for the occupant of this property who has mobility difficulty. The resident holds an Australian Disabled Parking Permit.

In accordance with Australian Standard *AS2890.5 Parking*. Any parallel parking spaces marked as disabled parking bay should be 3.2m wide and 7.8m long and it should also have kerb ramps provided.

As a responsible authority, Council is expected to meet the applicable standards when providing facilities for people with disabilities. Marking a space as an accessible parking space with the international symbol should be an indicator to users that the standard has been met. The provision of parking spaces for people with disabilities is not a matter of just installing signage.

Council regularly receives requests from residents for the provision of a parking space for people with a disability adjoining their residence. Each request is reviewed on merit, and assessed against the Australian Standard. An assessment is made to determine whether the resident has access to off-street parking, or whether they could make reasonable changes to their property to provide off-street parking. Where this is not possible, the site is assessed for availability of parking. Site visits are made at different times to gauge parking occupancy rates in the street. This provides an indication of how frequently residents would experience difficulty in obtaining parking near their residence. Site visits will also enable an assessment of how close the property is located to other facilities that would support a greater public need for the provision of a parking area for people with a

disability. Observations will also be made to enable assessment against the standard in terms of dimension and gradients, and potential alternative arrangements.

The property is located on an embankment, with approximately 14 stairs. There is no off-street parking, and no practical way for the resident to modify their property to provide parking without major construction works. The demand for on-street parking is exacerbated by the fact that several other adjoining properties have no access to off-street parking.

The resident's family find it difficult to set down and pick up when there is a vehicle parked in front of the house.

The current kerb and footpath infrastructure in front of 14 Trevelyan Street does not allow for the required space for a disabled parking bay according to the current Australian Standards. Two other nearby disabled parking spaces have been provided adjacent to Nos. 18 and 21, and both fail to comply with the current Australian Standards.

As an alternative to the requested disabled parking bay, it is proposed that 1 hour parking limit be provided at the subject location. The proposed 1P parking increases parking turnover, and enable current NSW Mobility Parking Scheme Holders, to park for an unrestricted time in the 1P timed parking zone.

As with any regulatory control, ongoing operation of the space depends on a degree of self-regulation. The location is somewhat removed from high priority locations such as schools and town centres.

The locality of the proposed and existing parking, is shown in the attached drawing.

Financial Implications

Not applicable	<input type="checkbox"/>	
Included in existing approved budget	<input checked="" type="checkbox"/>	The cost of the installation of the traffic signage will be covered from the RMS Block Grant for traffic facilities
Additional funds required	<input type="checkbox"/>	<<Enter comment if required or delete>>

Community Engagement

Community Consultation may be required.

Attachments

14 Trevelyan Street proposed 1P map



Bayside Traffic Committee

7/02/2018

Item No	BTC18.017
Subject	Waines Crescent southern leg, northern kerb line, west of Princes Highway, Rockdale - Proposed conversion of 'Loading Zone, 24/7' to a combined 'Loading Zone, 11am - 4pm, Mon - Fri' and 'No Stopping, at other times'
Report by	Pintara Lay, Coordinator Traffic and Road Safety
File	SC18/2
Electorate	Rockdale

Summary

Council has received a request to remove the existing Loading zone along the northern kerb line, from the southern leg of Waines Crescent, west of Princes Highway, Rockdale.

Parking issue in Waines Crescent was previously considered by Rockdale Traffic Committee at its meeting on 9/5/2007, Item RT13. The Committee recommended to install the Loading Zone to assist local businesses.

Officer Recommendation

That approval be given to the conversion of a 10m 'Loading zone' to a combined 'Loading Zone, 11 am – 4 pm, Mon – Fri' and a 'No Stopping, At Other Times' zone along the northern kerb line of Waines Crescent, west of Princes Highway at the side of 425 Princes Highway, Rockdale.

Background

Waines Crescent west of Princes Hwy is a narrow one way street travelling in the clockwise direction. The road carriage width is approximately 4.5m wide.

Parking in this laneway is restricted to:

- a 'Loading Zone' on the northern kerb line and
- a '30 Minute Parking' Zone on the eastern kerb line
- 'No Stopping' zones around the corners and near Princes Highway

The Loading Zone was established to assist loading and unloading to some businesses in the area.

A request has been received by Council concerned with parked vehicle in the loading zone creating access difficulties for trucks to manoeuvre safely. It has been reported that damage has been sustained to buildings by vehicles attempting to manoeuvre in this location.

In January 2018, consultation was carried out with affected local business people to consider the parking and loading concerns. A compromised solution was identified to convert the existing Loading Zone (24/7) to a combined 'Loading zone, 11 am – 4 pm, Mon – Fri; with a 'No Stopping, at other times' restrictions.

It was noted that some 'No Stopping' signs in Waines Crescent had been removed by persons unknown, and will be reinstated.

The locality of the existing and proposed parking restrictions in Waines Crescent, is shown in the attached drawing TC1429.

Financial Implications

Not applicable	<input type="checkbox"/>	
Included in existing approved budget	<input checked="" type="checkbox"/>	The conversion of the Loading zone will be funded through Traffic Facilities Fund
Additional funds required	<input type="checkbox"/>	<<Enter comment if required or delete>>

Community Engagement

Affected business people in Waines Crescent to be advised of Council's decision.

Attachments

- 1 Waines Crescent west of Princes Highway proposed combined Loading Zone and No Stopping Picture
- 2 Waines Crescent proposed combined Loading Zone and No Stopping TC1429 drawing



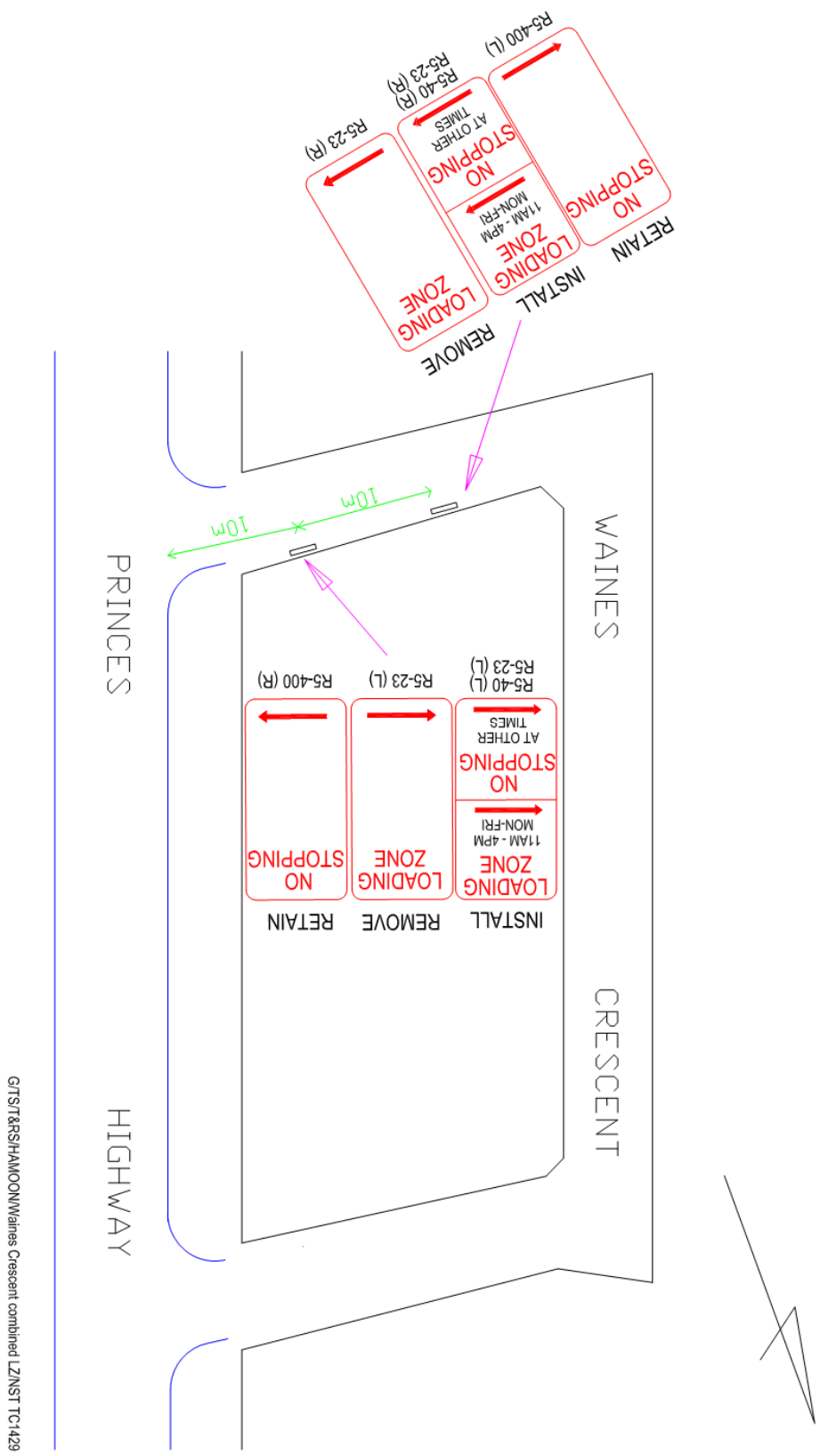

GTS/TS&RS/HAMMOON/Wainies Crescent combined L2/NST TC1429

Bayside Traffic Committee

7/02/2018

Item No	BTC18.018
Subject	General Business Session - Additional Items
Report by	Pintara Lay, Coordinator Traffic and Road Safety
File	SC18/2
Electorate	Heffron, Kogarah, Maroubra, Rockdale

Summary

Items without notice

Items which do not appear on the agenda (i.e. items without notice), must only be considered if the elected Council has referred the issue and Council officers have been able to prepare a report on the proposal in the normal manner. Items raised without notice must be referred to the next meeting (or dealt with separately between meetings) if any member of the committee requests time to consider the issue.

All other Items without notice will be referred to Council officers in the first instance, unless the members of the Committee agree to consider the item.

Matters that have been investigated and warrant the exercise of the Delegation to Council for the Regulation of Traffic, will be referred to the Bayside Traffic Committee at the next available opportunity.

Other matters that have been investigated and do not require exercise of the Delegation to Council are dealt with as administrative matters and the appropriate response and action will be provided (eg. providing advice to customers, referral of matters to the relevant authority, replacement of missing signs, repainting line marking, etc). These matters will not be referred to the Bayside Traffic Committee.

Informal Items - Traffic Engineering Advice

In accordance with the Roads and Maritime Service Guidelines, the Bayside Traffic Committee (BTC) members may wish to consider traffic issues or seek advice, on matters that are outside the Delegation to Council for the Regulation of Traffic from the Roads and Maritime Service (e.g. installation of speed limits or traffic control signals). As these issues do not require the exercise of delegated functions at that point in time (though they may or may not require it in the future) they should not be dealt with as formal items by the BTC. The BTC members may take advantage of the knowledge and experience of the other members to help them to resolve or clarify an issue. When wishing to utilise the expertise of the BTC members in this manner, Council will include items on the agenda under a separate Informal Items section. Informal items should be dealt with following the completion of formal BTC items where Council intends to exercise a delegated function. Any outcomes from discussions on informal items cannot be included in the BTC report to the Council. However, Council can use any outcomes from these discussions in their deliberations on such issues.

Officer Recommendation

That the matter raised be investigated.

- 1 That <<Enter text or delete if only one recommendation>>
 - 2 That <<Enter text or delete if only one recommendation>>
-

Background

<<Enter text>>

Financial Implications

Not applicable	<input checked="" type="checkbox"/>	
Included in existing approved budget	<input type="checkbox"/>	<<Enter comment if required or delete>>
Additional funds required	<input type="checkbox"/>	<<Enter comment if required or delete>>

Community Engagement

<<type Not applicable or enter text>>

Attachments

Nil